

GSE CurtainWall Interlock[®], Connection and Joint (Dimensions)

(Patented and other patents pending)
Scale = Full

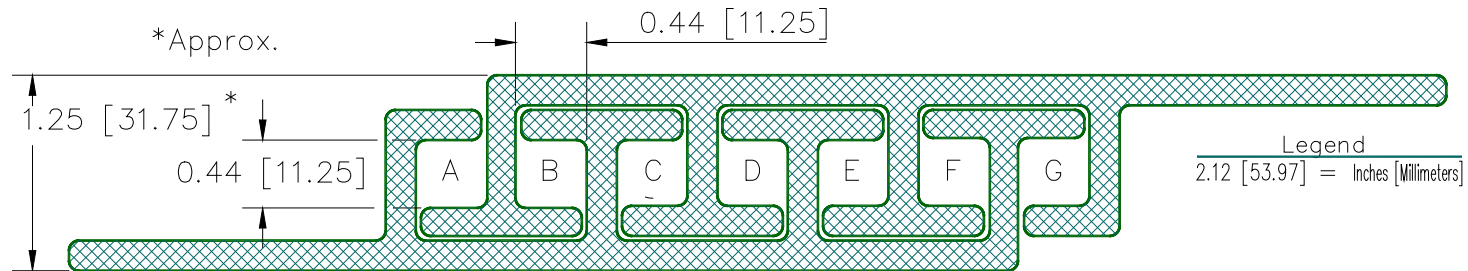

A thru G are potential monitoring or sealant chambers



GSE Lining Technology, Inc.

19103 Gundie Road
Houston, Texas 77073-3598
(800)435-2008 / (281)443-8564

NO PART OF THIS DOCUMENT MAY BE REPRODUCED OR DISTRIBUTED IN ANY FORM OR BY ANY MEANS, OR STORED IN A DATA BASE OR RETRIEVAL SYSTEM, WITHOUT THE PRIOR WRITTEN PERMISSION OF GSE Lining Technology, Inc.

DRAWN

Don

DATE

12/15/98

REVISION

1

DWG. NO.

D-CW001

THIS IS A CONCEPTUAL DRAWING SOLELY FOR USE BY ENGINEERS AS A GENERAL GUIDELINE IN FORMULATING SITE SPECIFIC ENGINEERING DRAWINGS. NO DESCRIPTION OF MATERIALS OR THIS DESIGN CREATES OR AMOUNTS TO AN EXPRESS WARRANTY, OR IMPLIED WARRANTY OF MERCHANTABILITY OR FITNESS FOR A PARTICULAR PURPOSE.

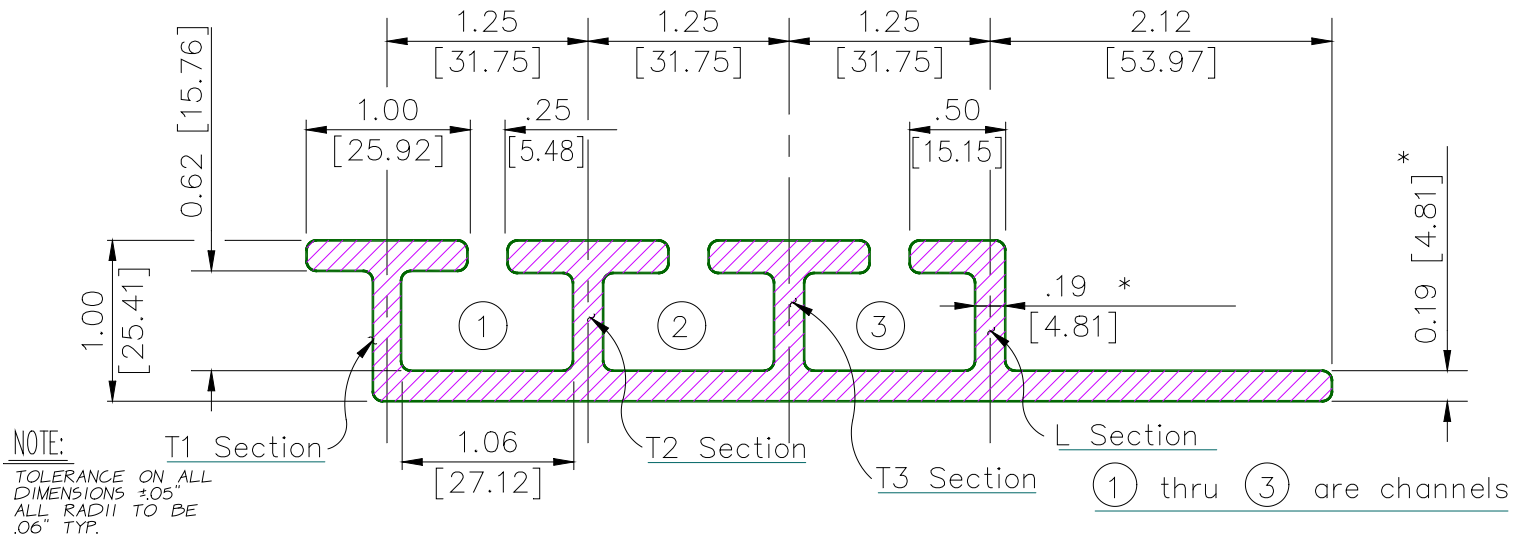

GSE CurtainWall Interlock[®], Connection and Joint (Dimensions)

(Patented and other patents pending)
Scale = Full

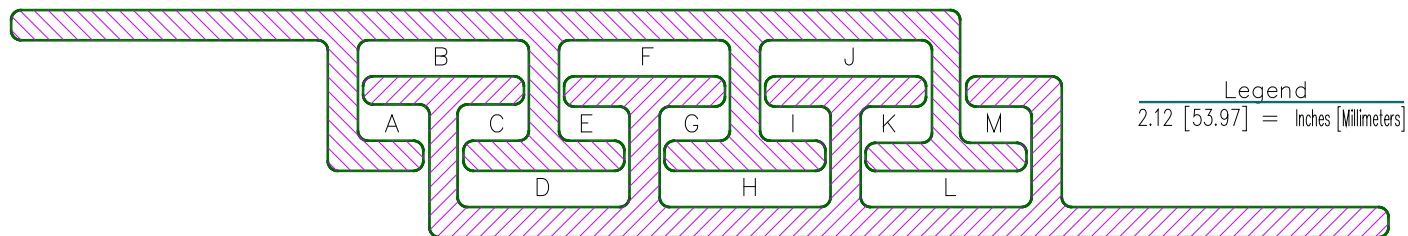

A thru M are potential monitoring or sealant chambers



GSE Lining Technology, Inc.

19103 Gundle Road
Houston, Texas 77073-3598
(800)435-2008 / (281)443-8564

NO PART OF THIS DOCUMENT MAY BE REPRODUCED OR DISTRIBUTED IN ANY FORM OR BY ANY MEANS, OR STORED IN A DATA BASE OR RETRIEVAL SYSTEM, WITHOUT THE PRIOR WRITTEN PERMISSION OF GSE Lining Technology, Inc.

DRAWN

Don

DATE

12/15/98

REVISION

1

DWG. NO.

D-CW001A

THIS IS A CONCEPTUAL DRAWING SOLELY FOR USE BY ENGINEERS AS A GENERAL GUIDELINE IN FORMULATING SITE SPECIFIC ENGINEERING DRAWINGS. NO DESCRIPTION OF MATERIALS OR THIS DESIGN CREATES OR AMOUNTS TO AN EXPRESS WARRANTY, OR IMPLIED WARRANTY OF MERCHANTABILITY OR FITNESS FOR A PARTICULAR PURPOSE.

NOTE:

TOLERANCE ON ALL
DIMENSIONS $\pm .05"$
ALL RADII TO BE
.06" TYP.

Legend

2.12[53.97] = inches[millimeters]

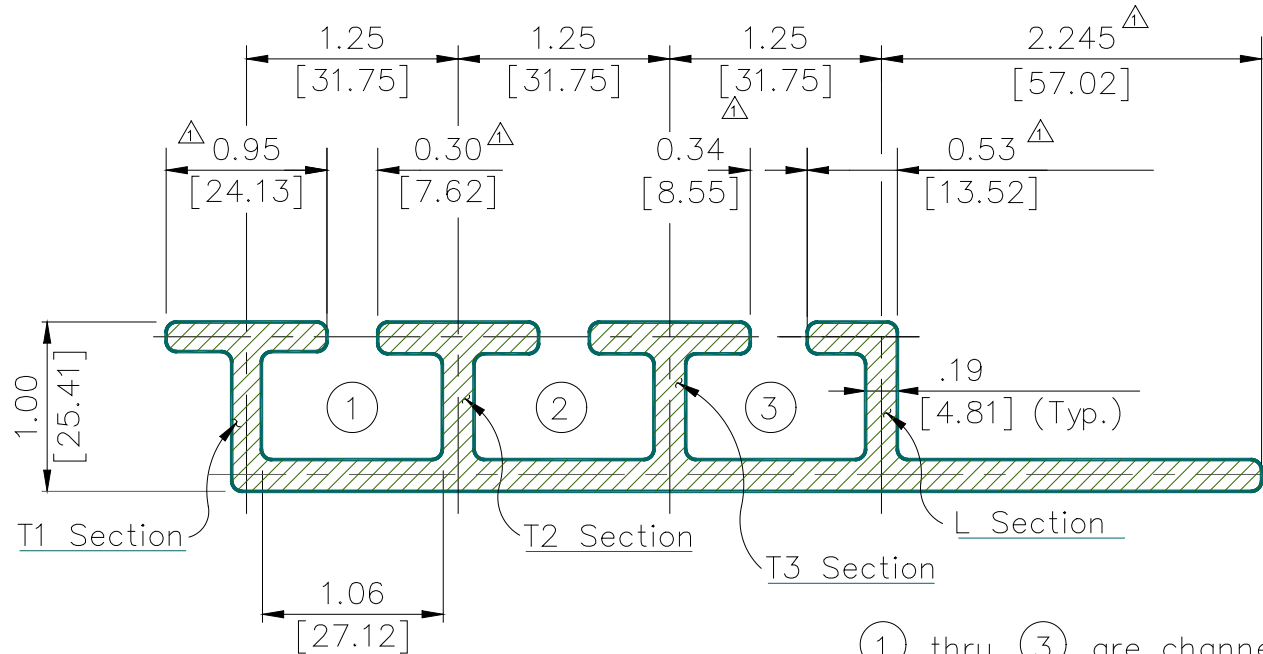

GSE Curtainwall Interlock® Connection (Dimensions)

(Patented and other patents pending)

Scale = Full



GSE Lining Technology, Inc.

19103 Gundle Road
Houston, Texas 77073-3598
(800)435-2008 / (281)443-8564

NO PART OF THIS DOCUMENT MAY BE REPRODUCED OR DISTRIBUTED IN ANY FORM OR BY ANY MEANS, OR STORED IN A DATA BASE OR RETRIEVAL SYSTEM, WITHOUT THE PRIOR WRITTEN PERMISSION OF GSE Lining Technology, Inc.

THIS IS A CONCEPTUAL DRAWING SOLELY FOR USE BY ENGINEERS AS A GENERAL GUIDELINE IN FORMULATING SITE SPECIFIC ENGINEERING DRAWINGS. NO DESCRIPTION OF MATERIALS OR THIS DESIGN CREATES OR AMOUNTS TO AN EXPRESS WARRANTY, OR IMPLIED WARRANTY OF MERCHANTABILITY OR FITNESS FOR A PARTICULAR PURPOSE.

DRAWN

Don

DATE

12/15/98

REVISION

1

DWG. NO.

D-CW002

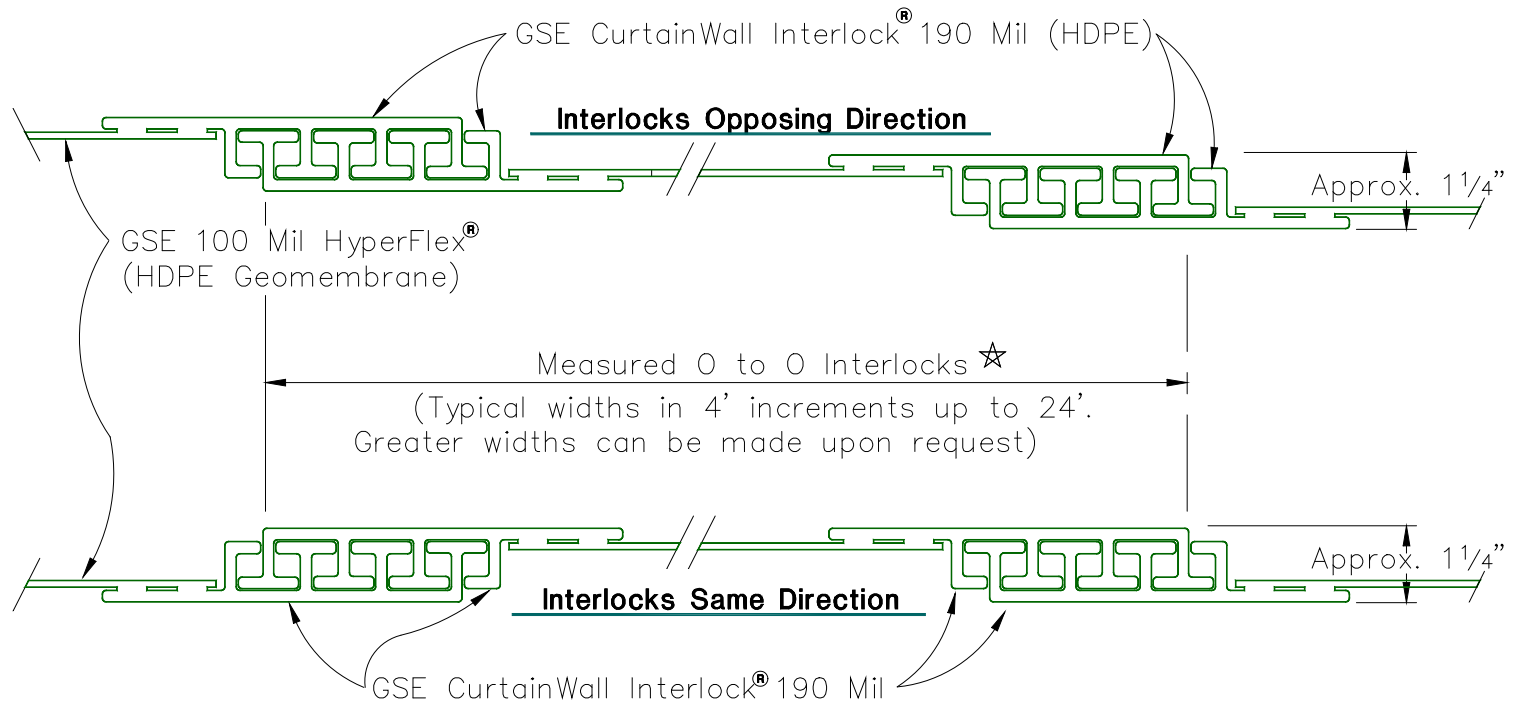

Section Thru Typical CurtainWall® Panels

(Patented and other patents pending)
Not to scale

Drawing 2

★ Note: Measured dimensions are
fabricated with tolerances of 2"



GSE Lining Technology, Inc.

19103 Gundie Road
Houston, Texas 77073-3598
(800)435-2008 / (281)443-8564

NO PART OF THIS DOCUMENT MAY BE REPRODUCED OR DISTRIBUTED IN ANY FORM OR BY ANY MEANS, OR STORED IN A DATA BASE OR RETRIEVAL SYSTEM, WITHOUT THE PRIOR WRITTEN PERMISSION OF GSE Lining Technology, Inc.

THIS IS A CONCEPTUAL DRAWING SOLELY FOR USE BY ENGINEERS AS A GENERAL GUIDELINE IN FORMULATING SITE SPECIFIC ENGINEERING DRAWINGS. NO DESCRIPTION OF MATERIALS OR THIS DESIGN CREATES OR AMOUNTS TO AN EXPRESS WARRANTY, OR IMPLIED WARRANTY OF MERCHANTABILITY OR FITNESS FOR A PARTICULAR PURPOSE.

DRAWN

Don

DATE

12/15/98

REVISION

1

DWG. NO.

D-CW003

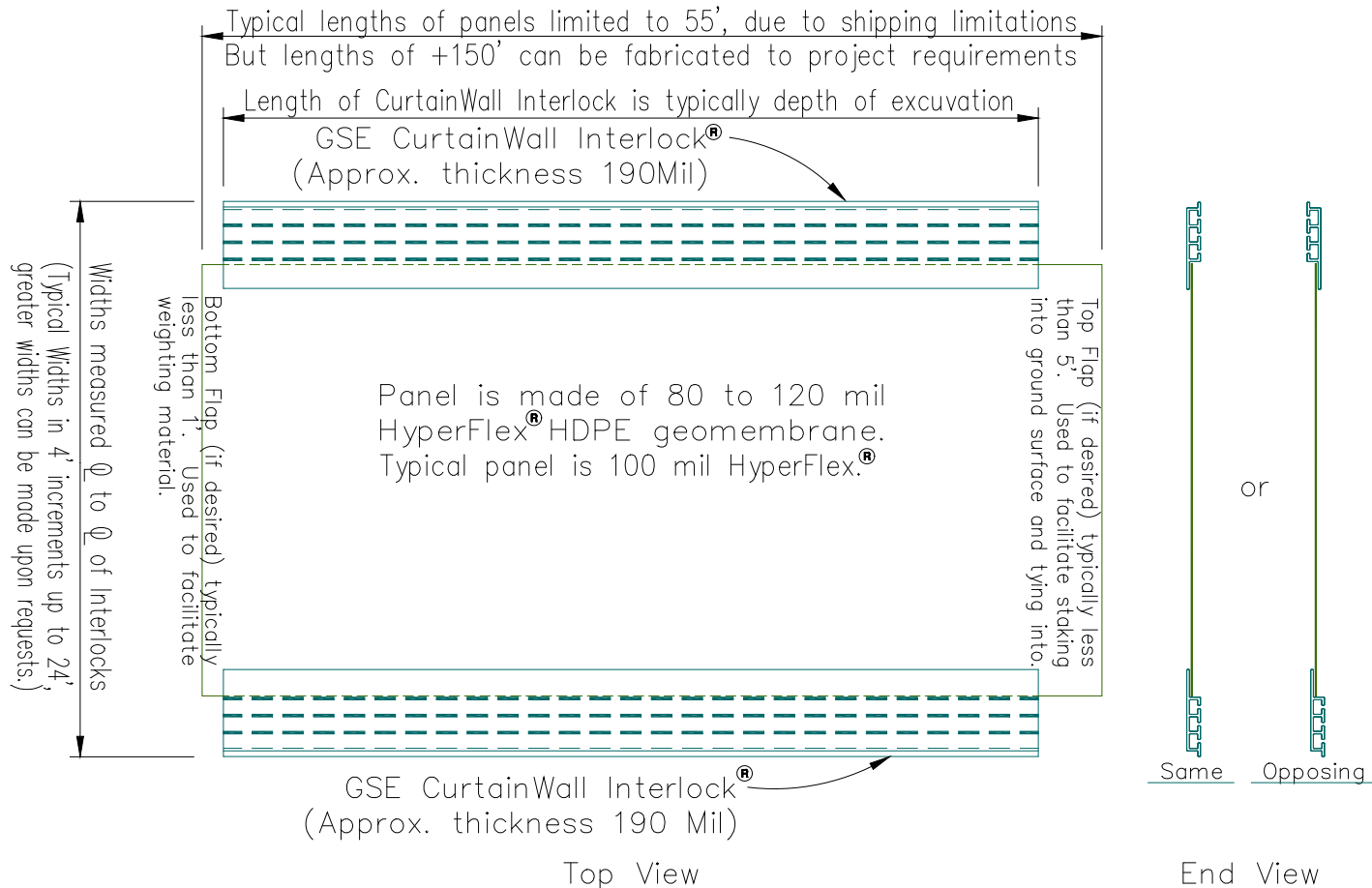

GSE CurtainWall® Panel

Not to scale

☆ Note: Measured dimensions are fabricated with tolerances of 2"



GSE Lining Technology, Inc.

19103 Gundle Road
Houston, Texas 77073-3598
(800)435-2008 / (281)443-8564

NO PART OF THIS DOCUMENT MAY BE REPRODUCED OR DISTRIBUTED IN ANY FORM OR BY ANY MEANS, OR STORED IN A DATA BASE OR RETRIEVAL SYSTEM, WITHOUT THE PRIOR WRITTEN PERMISSION OF GSE Lining Technology, Inc.

THIS IS A CONCEPTUAL DRAWING SOLELY FOR USE BY ENGINEERS AS A GENERAL GUIDELINE IN FORMULATING SITE SPECIFIC ENGINEERING DRAWINGS. NO DESCRIPTION OF MATERIALS OR THIS DESIGN CREATES OR AMOUNTS TO AN EXPRESS WARRANTY, OR IMPLIED WARRANTY OF MERCHANTABILITY OR FITNESS FOR A PARTICULAR PURPOSE.

DRAWN

Don

DATE

12/15/98

REVISION

1

DWG. NO.

D-CW004

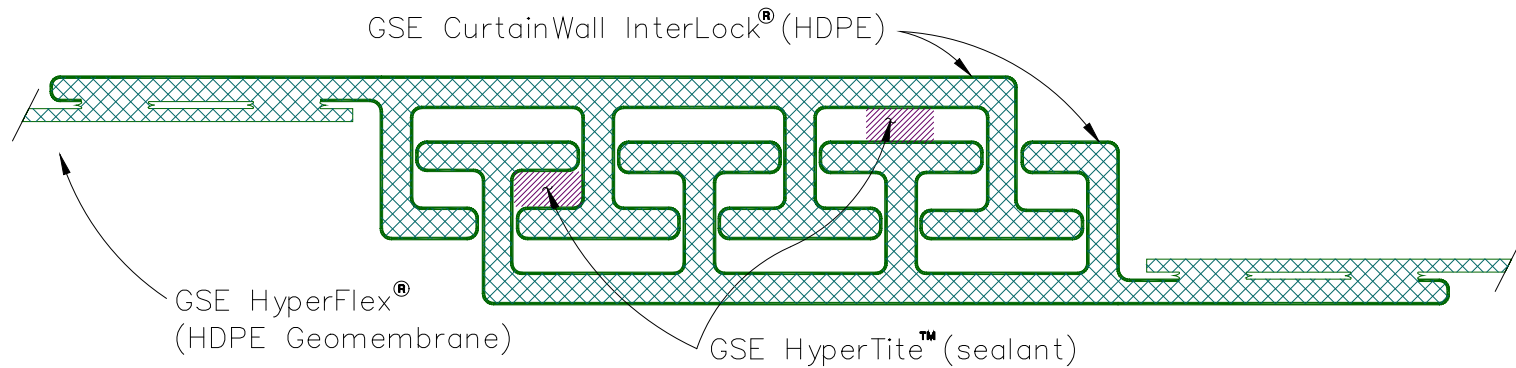
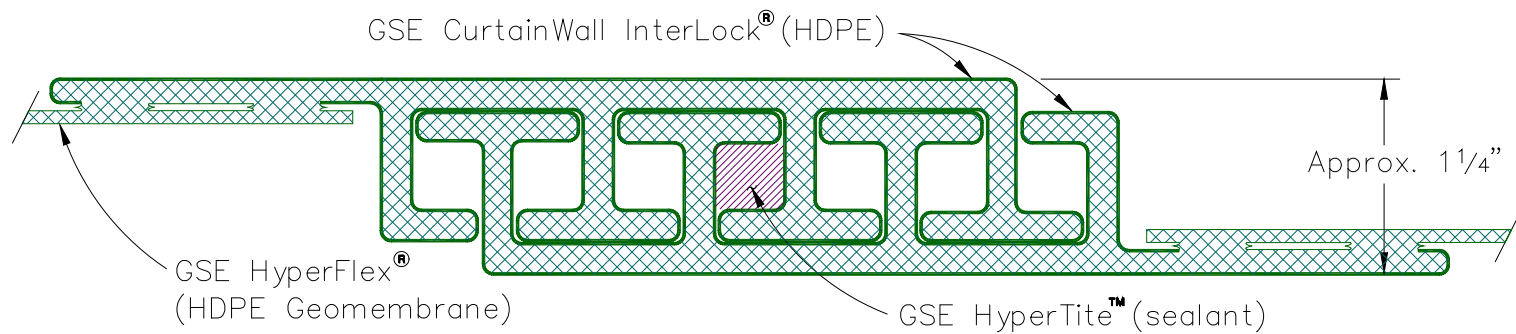

GSE CurtainWall[®] System With GSE HyperTite[™]

Not to scale



GSE Lining Technology, Inc.

19103 Gundie Road
Houston, Texas 77073-3598
(800)435-2008 / (281)443-8564

NO PART OF THIS DOCUMENT MAY BE REPRODUCED OR DISTRIBUTED IN ANY FORM OR BY ANY MEANS, OR STORED IN A DATA BASE OR RETRIEVAL SYSTEM, WITHOUT THE PRIOR WRITTEN PERMISSION OF GSE Lining Technology, Inc.

DRAWN

Don

DATE

12/15/98

REVISION

1

DWG. NO.

D-CW005

THIS IS A CONCEPTUAL DRAWING SOLELY FOR USE BY ENGINEERS AS A GENERAL GUIDELINE IN FORMULATING SITE SPECIFIC ENGINEERING DRAWINGS. NO DESCRIPTION OF MATERIALS OR THIS DESIGN CREATES OR AMOUNTS TO AN EXPRESS WARRANTY, OR IMPLIED WARRANTY OF MERCHANTABILITY OR FITNESS FOR A PARTICULAR PURPOSE.

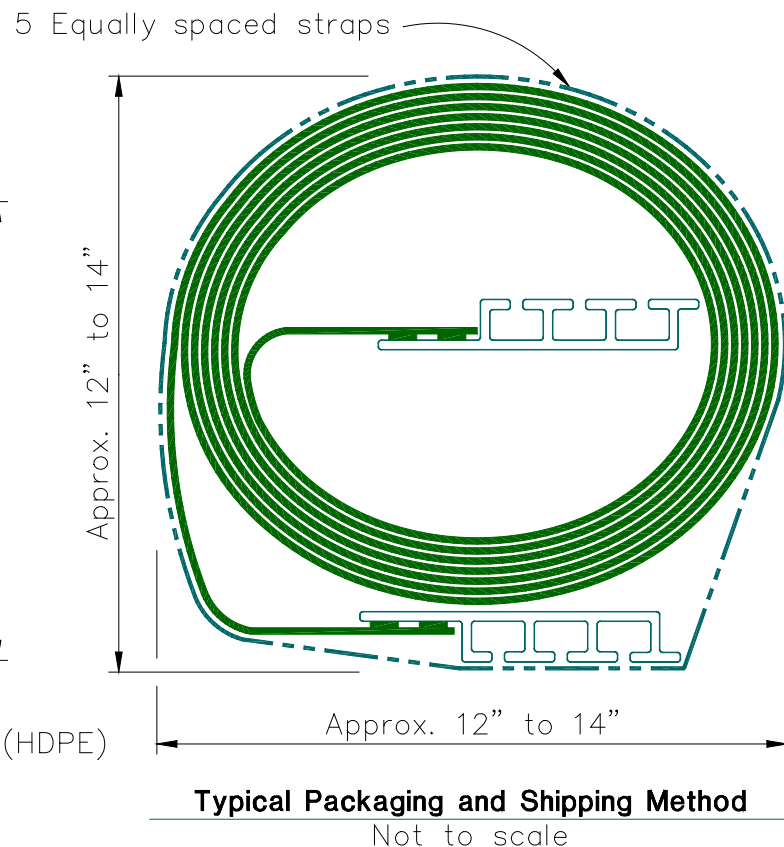
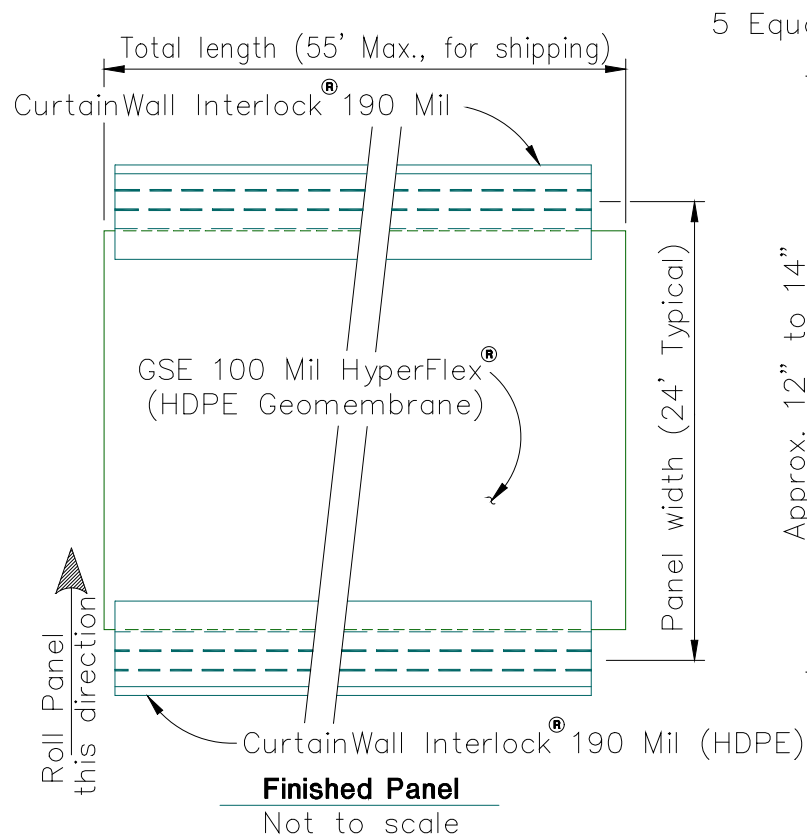

GSE CurtainWall® System Shipping and Packaging



GSE Lining Technology, Inc.

19103 Gundie Road
Houston, Texas 77073-3598
(800)435-2008 / (281)443-8564

NO PART OF THIS DOCUMENT MAY BE REPRODUCED OR DISTRIBUTED IN ANY FORM OR BY ANY MEANS, OR STORED IN A DATA BASE OR RETRIEVAL SYSTEM, WITHOUT THE PRIOR WRITTEN PERMISSION OF GSE Lining Technology, Inc.

THIS IS A CONCEPTUAL DRAWING SOLELY FOR USE BY ENGINEERS AS A GENERAL GUIDELINE IN FORMULATING SITE SPECIFIC ENGINEERING DRAWINGS. NO DESCRIPTION OF MATERIALS OR THIS DESIGN CREATES OR AMOUNTS TO AN EXPRESS WARRANTY, OR IMPLIED WARRANTY OF MERCHANTABILITY OR FITNESS FOR A PARTICULAR PURPOSE.

DRAWN

Don

DATE

12/15/98

REVISION

1

DWG. NO.

D-CW006

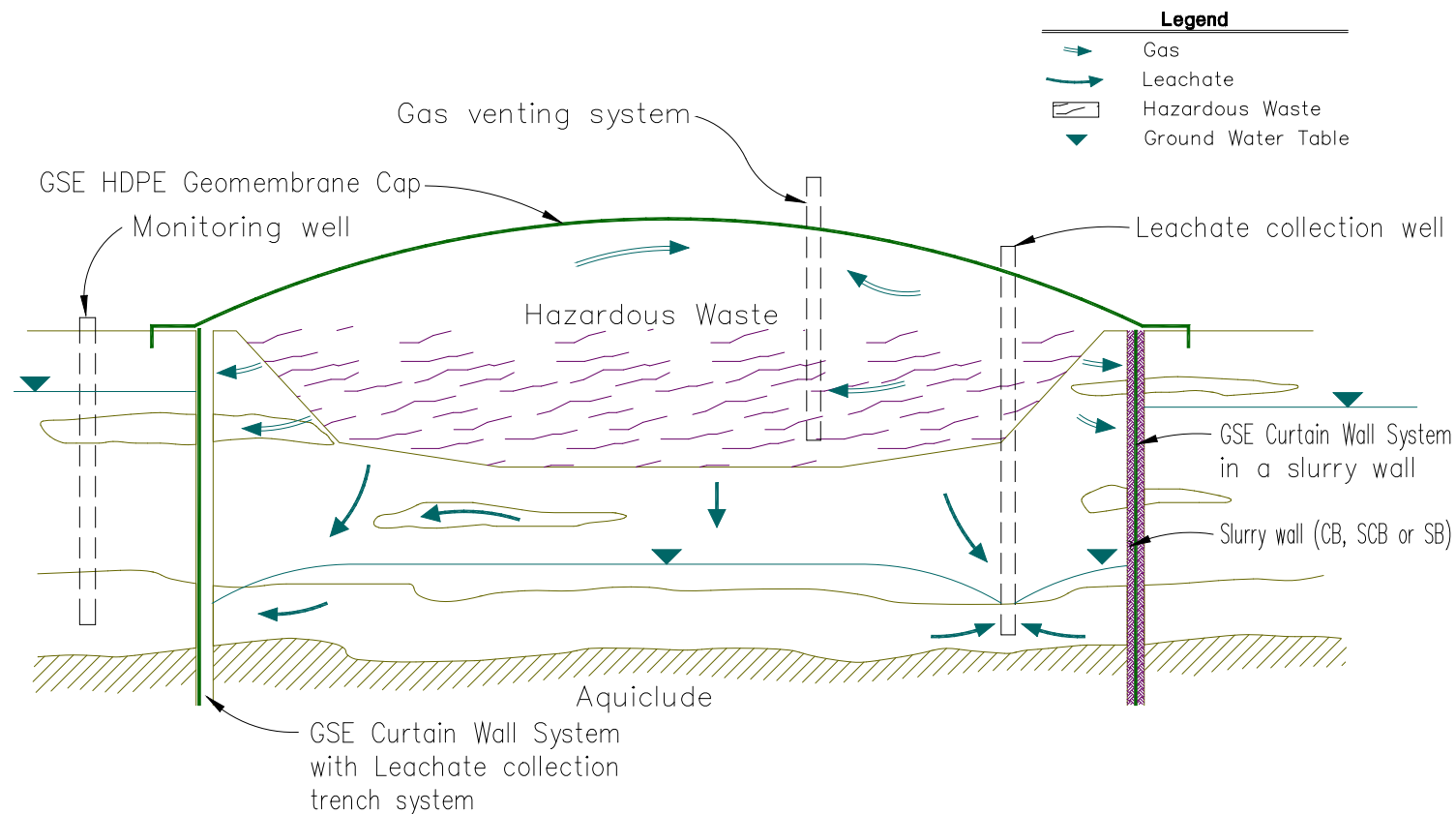

GSE Curtain Wall System with Closure Cap

Not to scale



GSE Lining Technology, Inc.

19103 Gundie Road
Houston, Texas 77073-3598
(800)435-2008 / (281)443-8564

NO PART OF THIS DOCUMENT MAY BE REPRODUCED OR DISTRIBUTED IN ANY FORM OR BY ANY MEANS, OR STORED IN A DATA BASE OR RETRIEVAL SYSTEM, WITHOUT THE PRIOR WRITTEN PERMISSION OF GSE Lining Technology, Inc.

THIS IS A CONCEPTUAL DRAWING SOLELY FOR USE BY ENGINEERS AS A GENERAL GUIDELINE IN FORMULATING SITE SPECIFIC ENGINEERING DRAWINGS. NO DESCRIPTION OF MATERIALS OR THIS DESIGN CREATES OR AMOUNTS TO AN EXPRESS WARRANTY, OR IMPLIED WARRANTY OF MERCHANTABILITY OR FITNESS FOR A PARTICULAR PURPOSE.

DRAWN

Don

DATE

12/15/98

REVISION

1

DWG. NO.

D-CW007

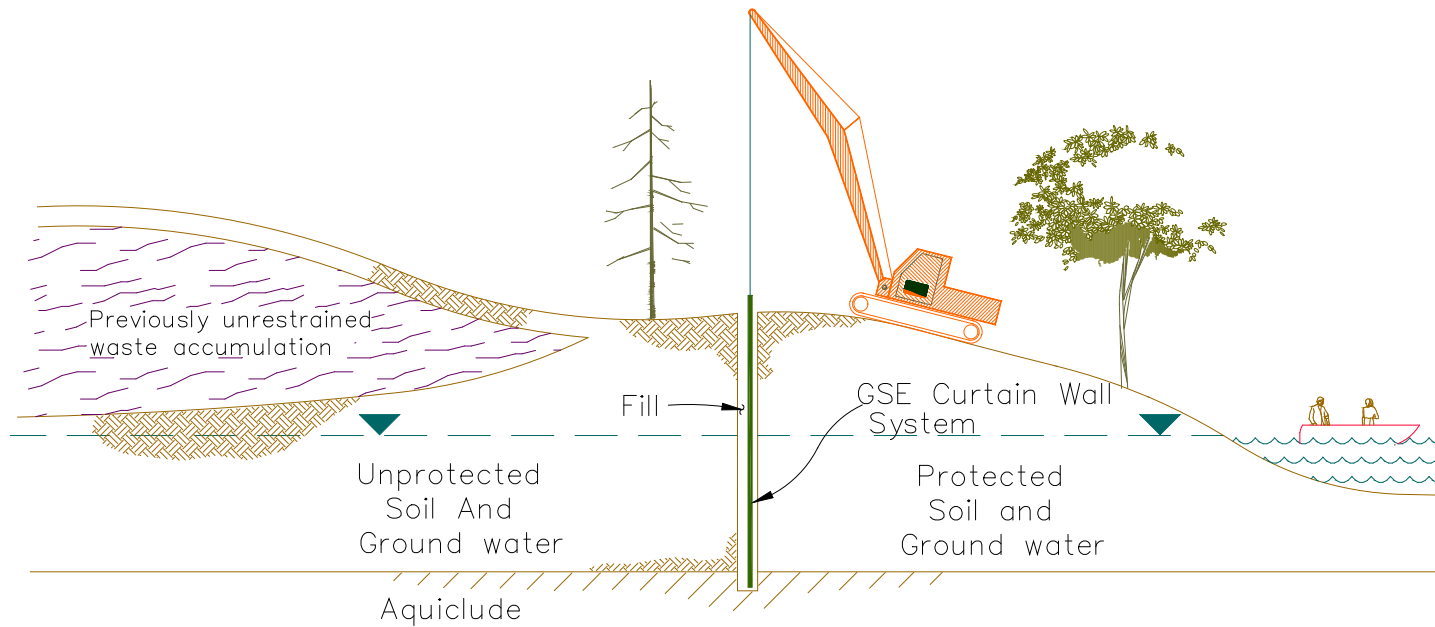

GSE Curtain Wall Systems Stop Migration

Not to scale



GSE Lining Technology, Inc.

19103 Gundie Road
Houston, Texas 77073-3598
(800)435-2008 / (281)443-8564

NO PART OF THIS DOCUMENT MAY BE REPRODUCED OR DISTRIBUTED IN ANY FORM OR BY ANY MEANS, OR STORED IN A DATA BASE OR RETRIEVAL SYSTEM, WITHOUT THE PRIOR WRITTEN PERMISSION OF GSE Lining Technology, Inc.

THIS IS A CONCEPTUAL DRAWING SOLELY FOR USE BY ENGINEERS AS A GENERAL GUIDELINE IN FORMULATING SITE SPECIFIC ENGINEERING DRAWINGS. NO DESCRIPTION OF MATERIALS OR THIS DESIGN CREATES OR AMOUNTS TO AN EXPRESS WARRANTY, OR IMPLIED WARRANTY OF MERCHANTABILITY OR FITNESS FOR A PARTICULAR PURPOSE.

DRAWN

Don

DATE

12/15/98

REVISION

1

DWG. NO.

D-CW008

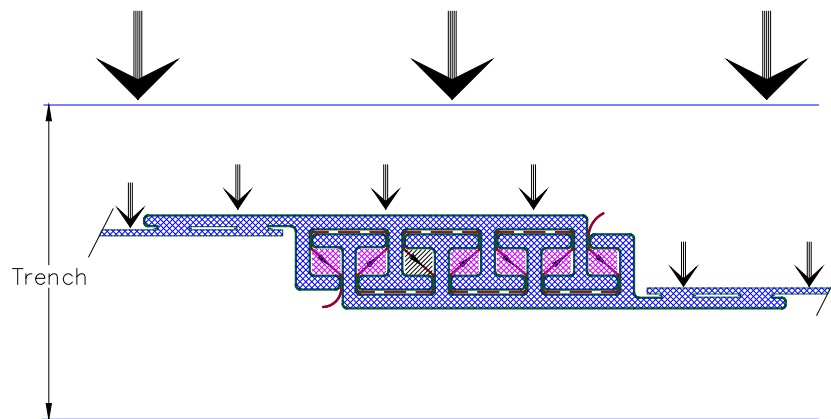

Concentration of leachate reaching
barrier of fill and CurtainWall®

Much reduced leachate concentration
reaching CurtainWall™

Tortuous path of about 13" for
leachate to pass CurtainWall
Interlock™

Cement-bentonite ($K \sim 10^{-7}$ cm/sec)
filled channels

Additional very low permeability and
chemically resistant sealant in one
or more channels

GSE CurtainWall® System



GSE Lining Technology, Inc.

19103 Gundie Road
Houston, Texas 77073-3598
(800)435-2008 / (281)443-8564

NO PART OF THIS DOCUMENT MAY BE REPRODUCED OR DISTRIBUTED IN ANY FORM OR BY ANY MEANS, OR STORED IN A DATA BASE OR RETRIEVAL SYSTEM, WITHOUT THE PRIOR WRITTEN PERMISSION OF GSE Lining Technology, Inc.

DRAWN

Don

DATE

12/15/98

REVISION

1

DWG. NO.

D-CW009

THIS IS A CONCEPTUAL DRAWING SOLELY FOR USE BY ENGINEERS AS A GENERAL GUIDELINE IN FORMULATING SITE SPECIFIC ENGINEERING DRAWINGS. NO DESCRIPTION OF MATERIALS OR THIS DESIGN CREATES OR AMOUNTS TO AN EXPRESS WARRANTY, OR IMPLIED WARRANTY OF MERCHANTABILITY OR FITNESS FOR A PARTICULAR PURPOSE.

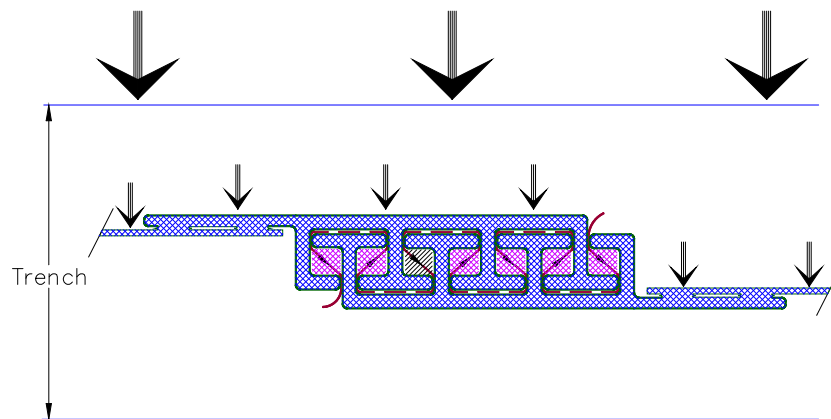

Concentration of leachate reaching
barrier of fill and CurtainWall[®]



Much reduced leachate concentration
reaching CurtainWall[™]



Torturous path of about 13" for
leachate to pass CurtainWall
Interlock[™]



Cement-bentonite ($K \sim 10^{-7}$ cm/sec)
filled channels



Additional very low permeability and
chemically resistant sealant in one
or more channels

GSE CurtainWall[®] System



GSE Lining Technology, Inc.

19103 Gundie Road
Houston, Texas 77073-3598
(800)435-2008 / (281)443-8564

NO PART OF THIS DOCUMENT MAY BE REPRODUCED OR DISTRIBUTED IN ANY FORM OR BY ANY MEANS, OR STORED IN A DATA BASE OR RETRIEVAL SYSTEM, WITHOUT THE PRIOR WRITTEN PERMISSION OF GSE Lining Technology, Inc.

DRAWN

Don

DATE

12/15/98

REVISION

1

DWG. NO.

D-CW009

THIS IS A CONCEPTUAL DRAWING SOLELY FOR USE BY ENGINEERS AS A GENERAL GUIDELINE IN FORMULATING SITE SPECIFIC ENGINEERING DRAWINGS. NO DESCRIPTION OF MATERIALS OR THIS DESIGN CREATES OR AMOUNTS TO AN EXPRESS WARRANTY, OR IMPLIED WARRANTY OF MERCHANTABILITY OR FITNESS FOR A PARTICULAR PURPOSE.

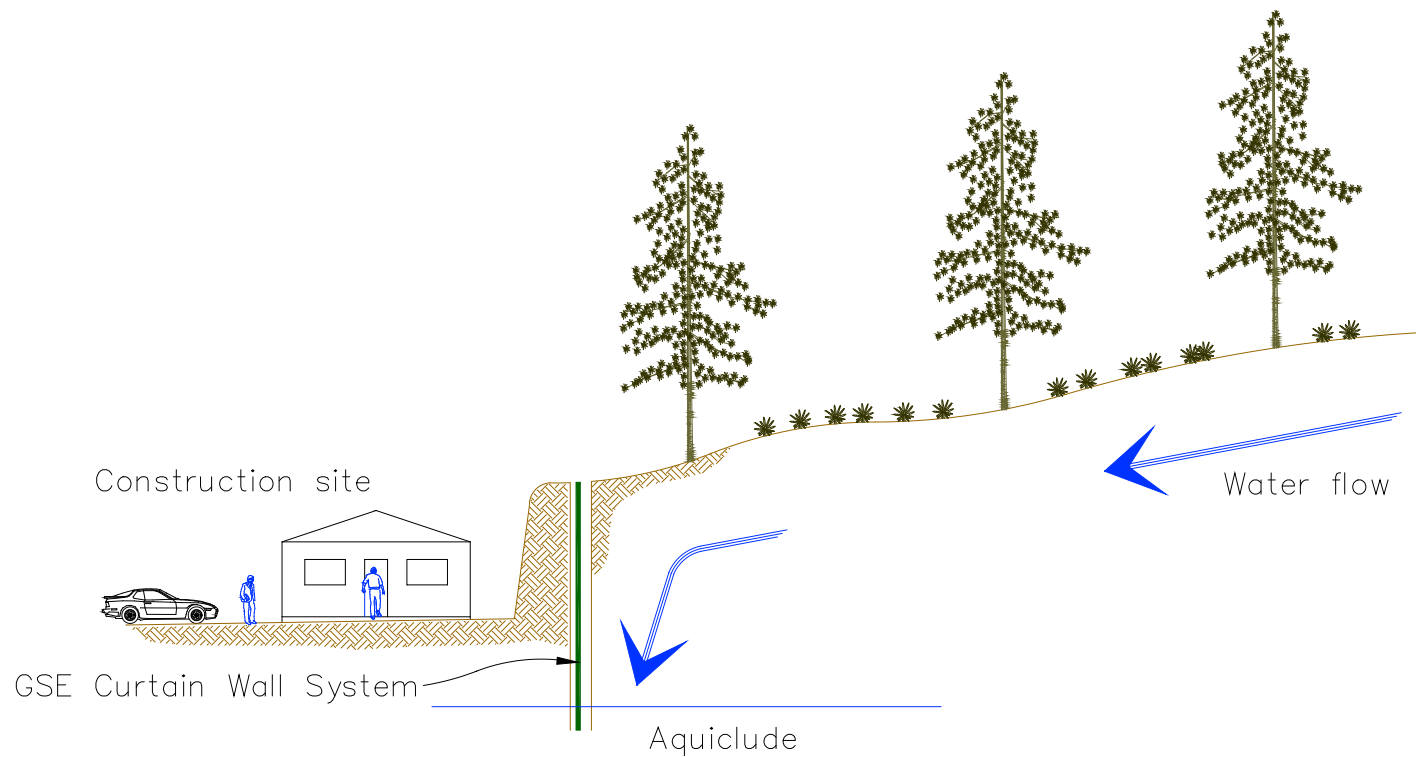

Water Flow Control With GSE Curtain Wall System

Not to scale



GSE Lining Technology, Inc.

19103 Gundie Road
Houston, Texas 77073-3598
(800)435-2008 / (281)443-8564

NO PART OF THIS DOCUMENT MAY BE REPRODUCED OR DISTRIBUTED IN ANY FORM OR BY ANY MEANS, OR STORED IN A DATA BASE OR RETRIEVAL SYSTEM, WITHOUT THE PRIOR WRITTEN PERMISSION OF GSE Lining Technology, Inc.

THIS IS A CONCEPTUAL DRAWING SOLELY FOR USE BY ENGINEERS AS A GENERAL GUIDELINE IN FORMULATING SITE SPECIFIC ENGINEERING DRAWINGS. NO DESCRIPTION OF MATERIALS OR THIS DESIGN CREATES OR AMOUNTS TO AN EXPRESS WARRANTY, OR IMPLIED WARRANTY OF MERCHANTABILITY OR FITNESS FOR A PARTICULAR PURPOSE.

DRAWN

Don

DATE

12/15/98

REVISION

1

DWG. NO.

D-CW011

Water Containment With GSE Curtain Wall System

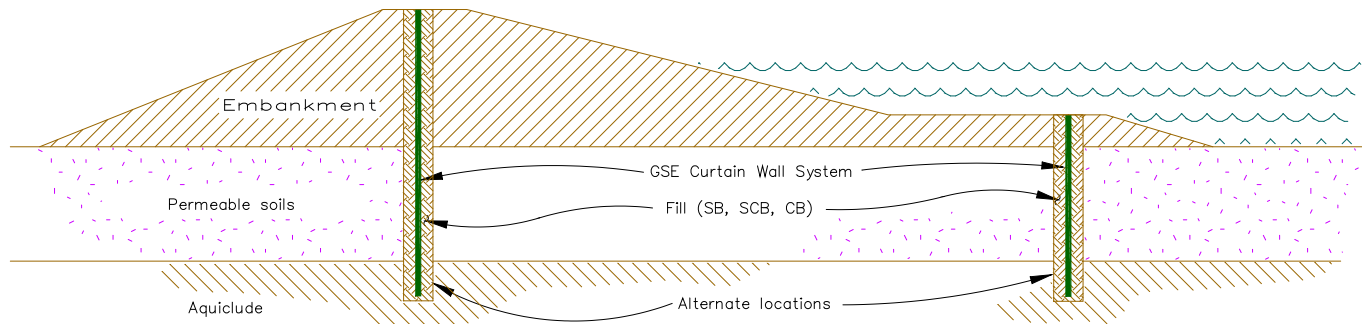

Cutoff Wall under or through existing or new Dam, Dike, Berm, Levee or Cofferdam



GSE Lining Technology, Inc.

19103 Gundie Road
Houston, Texas 77073-3598
(800)435-2008 / (281)443-8564

NO PART OF THIS DOCUMENT MAY BE REPRODUCED OR DISTRIBUTED IN ANY FORM OR BY ANY MEANS, OR STORED IN A DATA BASE OR RETRIEVAL SYSTEM, WITHOUT THE PRIOR WRITTEN PERMISSION OF GSE Lining Technology, Inc.

THIS IS A CONCEPTUAL DRAWING SOLELY FOR USE BY ENGINEERS AS A GENERAL GUIDELINE IN FORMULATING SITE SPECIFIC ENGINEERING DRAWINGS. NO DESCRIPTION OF MATERIALS OR THIS DESIGN CREATES OR AMOUNTS TO AN EXPRESS WARRANTY, OR IMPLIED WARRANTY OF MERCHANTABILITY OR FITNESS FOR A PARTICULAR PURPOSE.

DRAWN

Don

DATE

12/15/98

REVISION

1

DWG. NO.

D-CW012

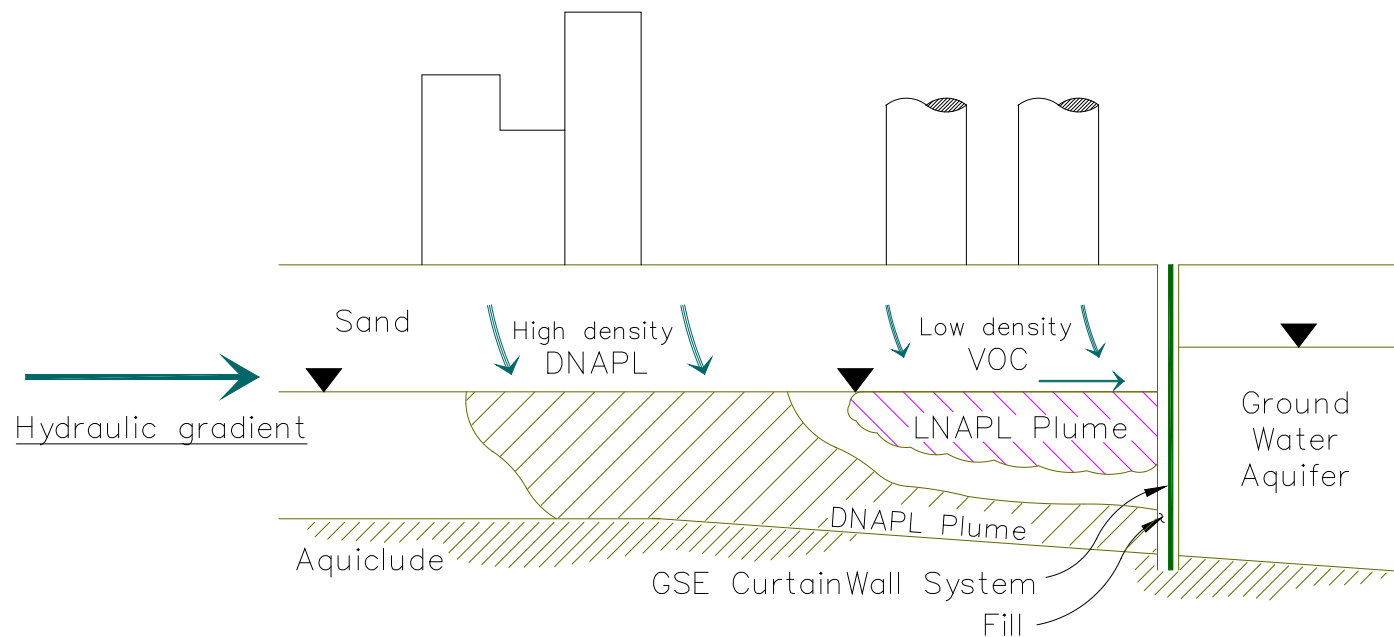

Hazardous Waste Containment With GSE CurtainWall[®] System

Not to scale



GSE Lining Technology, Inc.

19103 Gundie Road
Houston, Texas 77073-3598
(800)435-2008 / (281)443-8564

NO PART OF THIS DOCUMENT MAY BE REPRODUCED OR DISTRIBUTED IN ANY FORM OR BY ANY MEANS, OR STORED IN A DATA BASE OR RETRIEVAL SYSTEM, WITHOUT THE PRIOR WRITTEN PERMISSION OF GSE Lining Technology, Inc.

THIS IS A CONCEPTUAL DRAWING SOLELY FOR USE BY ENGINEERS AS A GENERAL GUIDELINE IN FORMULATING SITE SPECIFIC ENGINEERING DRAWINGS. NO DESCRIPTION OF MATERIALS OR THIS DESIGN CREATES OR AMOUNTS TO AN EXPRESS WARRANTY, OR IMPLIED WARRANTY OF MERCHANTABILITY OR FITNESS FOR A PARTICULAR PURPOSE.

DRAWN

Don

DATE

12/15/98

REVISION

1

DWG. NO.

D-CW013

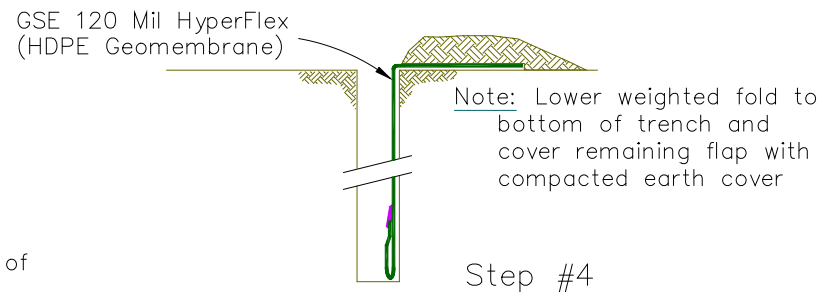
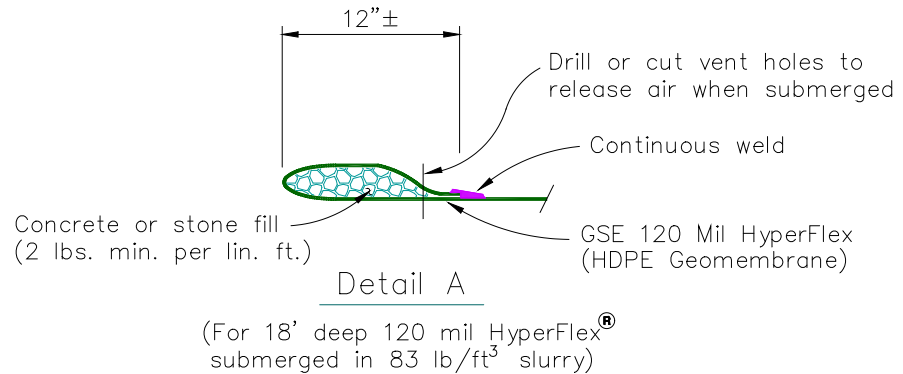
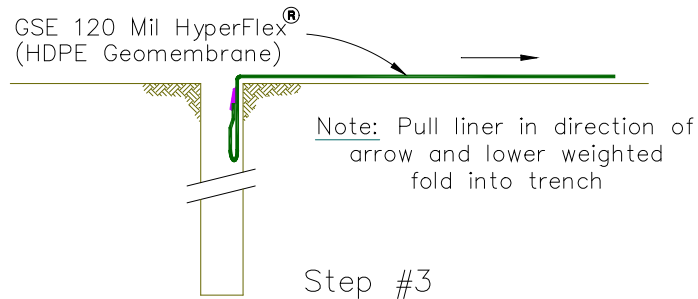
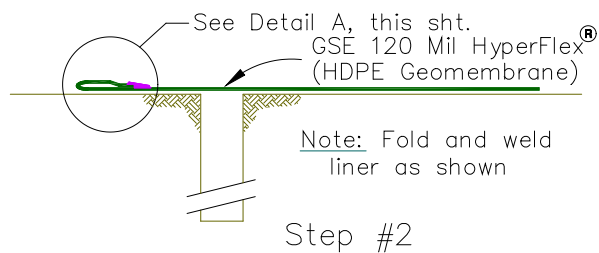
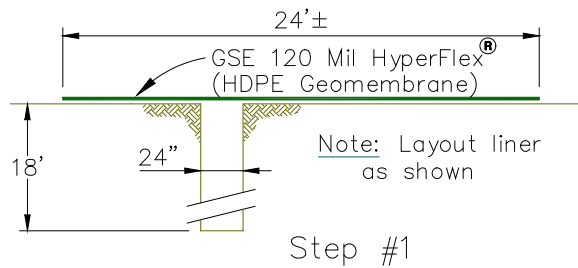

GSE CurtainWall™ System For Short Shallow Applications

Not to scale



GSE Lining Technology, Inc.

19103 Gundie Road
Houston, Texas 77073-3598
(800)435-2008 / (281)443-8564

NO PART OF THIS DOCUMENT MAY BE REPRODUCED OR DISTRIBUTED IN ANY FORM OR BY ANY MEANS, OR STORED IN A DATA BASE OR RETRIEVAL SYSTEM, WITHOUT THE PRIOR WRITTEN PERMISSION OF GSE Lining Technology, Inc.

THIS IS A CONCEPTUAL DRAWING SOLELY FOR USE BY ENGINEERS AS A GENERAL GUIDELINE IN FORMULATING SITE SPECIFIC ENGINEERING DRAWINGS. NO DESCRIPTION OF MATERIALS OR THIS DESIGN CREATES OR AMOUNTS TO AN EXPRESS WARRANTY, OR IMPLIED WARRANTY OF MERCHANTABILITY OR FITNESS FOR A PARTICULAR PURPOSE.

DRAWN

Don

DATE

12/15/98

REVISION

1

DWG. NO.

D-CW014

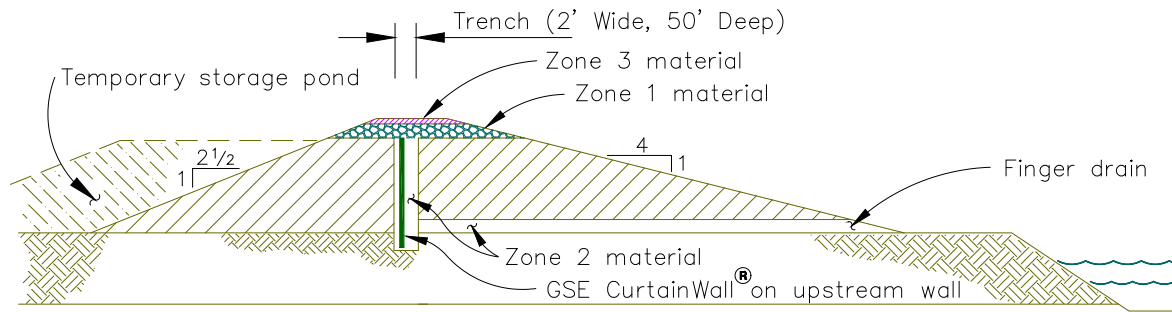

Cross-Section Thru Dike

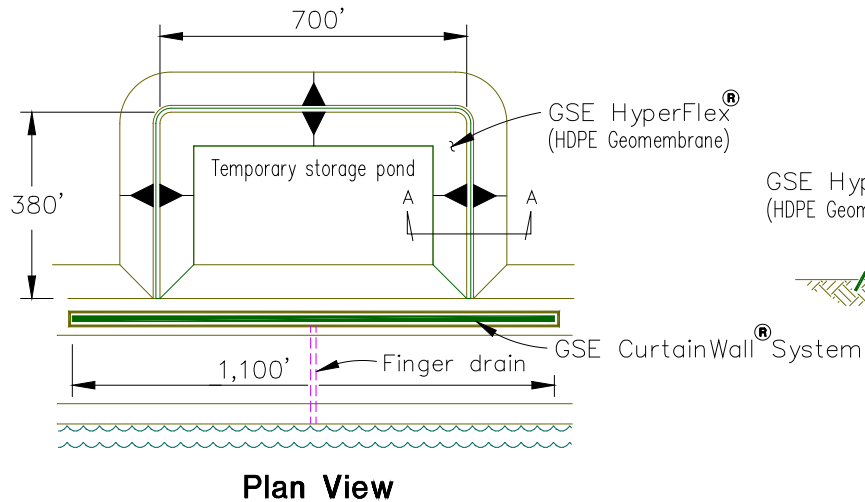

Plan View

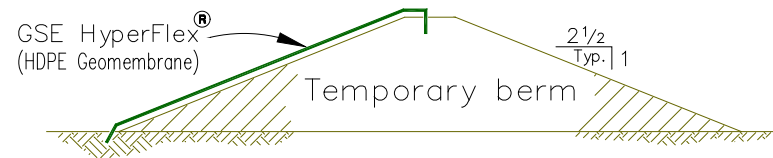

Section A - A

GSE CurtainWall® System on Reach 11 Dike Modification



GSE Lining Technology, Inc.

19103 Gundie Road
Houston, Texas 77073-3598
(800)435-2008 / (281)443-8564

NO PART OF THIS DOCUMENT MAY BE REPRODUCED OR DISTRIBUTED IN ANY FORM OR BY ANY MEANS, OR STORED IN A DATA BASE OR RETRIEVAL SYSTEM, WITHOUT THE PRIOR WRITTEN PERMISSION OF GSE Lining Technology, Inc.

DRAWN

Don

DATE

12/15/98

REVISION

1

DWG. NO.

D-CW015

THIS IS A CONCEPTUAL DRAWING SOLELY FOR USE BY ENGINEERS AS A GENERAL GUIDELINE IN FORMULATING SITE SPECIFIC ENGINEERING DRAWINGS. NO DESCRIPTION OF MATERIALS OR THIS DESIGN CREATES OR AMOUNTS TO AN EXPRESS WARRANTY, OR IMPLIED WARRANTY OF MERCHANTABILITY OR FITNESS FOR A PARTICULAR PURPOSE.

Control Ground Water Lateral Migration From Waste Disposal Sites With GSE Curtain Wall System

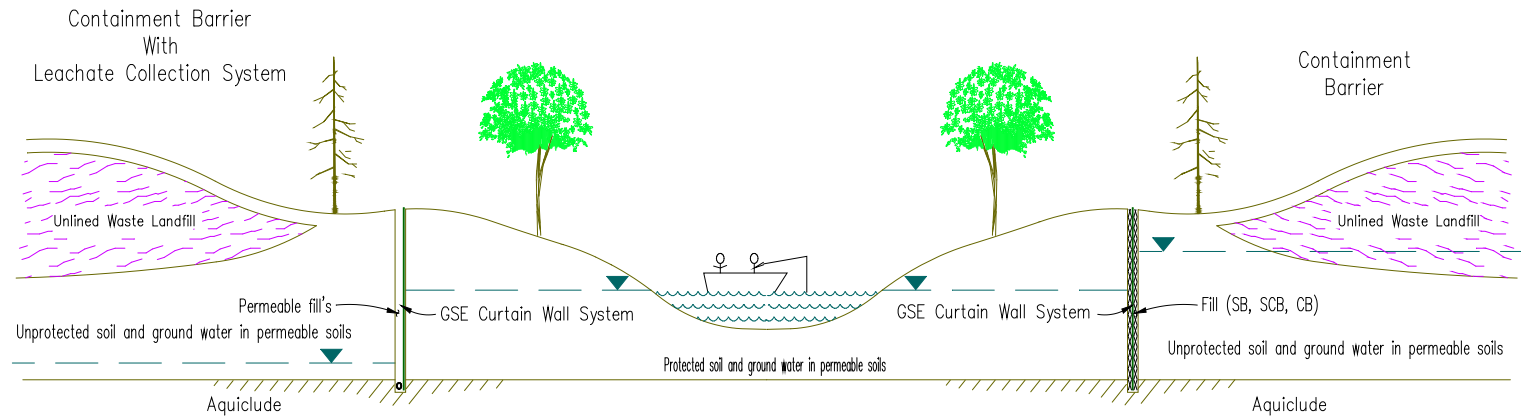

GSE Lining Technology, Inc.

19103 Gundie Road
Houston, Texas 77073-3598
(800)435-2008 / (281)443-8564

NO PART OF THIS DOCUMENT MAY BE REPRODUCED OR DISTRIBUTED IN ANY FORM OR BY ANY MEANS, OR STORED IN A DATA BASE OR RETRIEVAL SYSTEM, WITHOUT THE PRIOR WRITTEN PERMISSION OF GSE Lining Technology, Inc.

THIS IS A CONCEPTUAL DRAWING SOLELY FOR USE BY ENGINEERS AS A GENERAL GUIDELINE IN FORMULATING SITE SPECIFIC ENGINEERING DRAWINGS. NO DESCRIPTION OF MATERIALS OR THIS DESIGN CREATES OR AMOUNTS TO AN EXPRESS WARRANTY, OR IMPLIED WARRANTY OF MERCHANTABILITY OR FITNESS FOR A PARTICULAR PURPOSE.

DRAWN

Don

DATE

12/15/98

REVISION

1

DWG. NO.

D-CW016

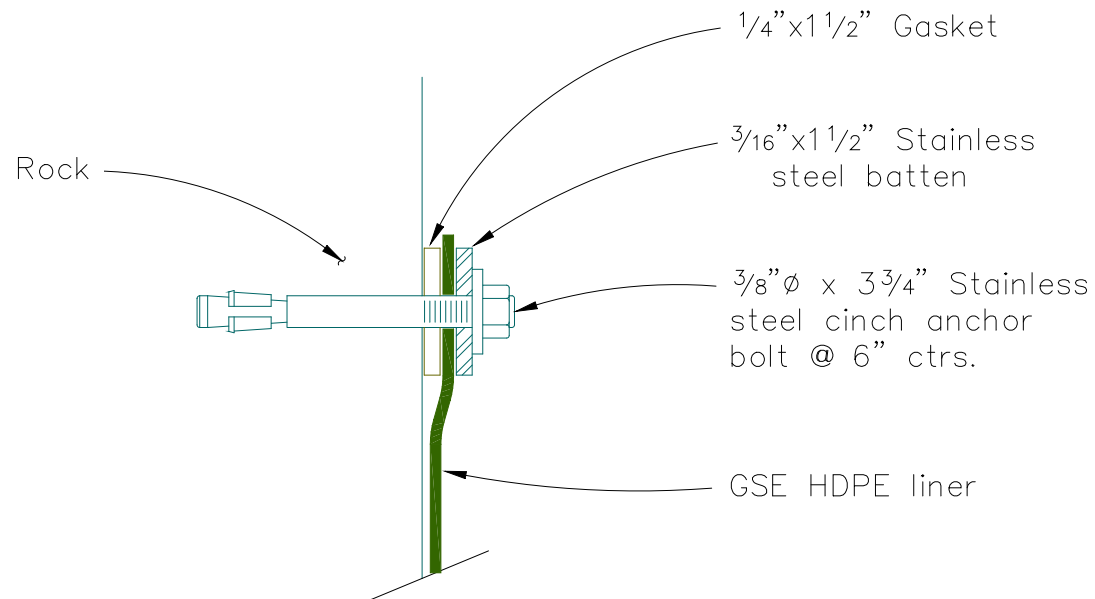

Rock Anchor Detail

Not to scale

NOTE: Due to irregularities in a rock surface GSE can not guarantee sealing integrity of this connection.



GSE Lining Technology, Inc.

19103 Gundie Road
Houston, Texas 77073-3598
(800)435-2008 / (281)443-8564

NO PART OF THIS DOCUMENT MAY BE REPRODUCED OR DISTRIBUTED IN ANY FORM OR BY ANY MEANS, OR STORED IN A DATA BASE OR RETRIEVAL SYSTEM, WITHOUT THE PRIOR WRITTEN PERMISSION OF GSE Lining Technology, Inc.

THIS IS A CONCEPTUAL DRAWING SOLELY FOR USE BY ENGINEERS AS A GENERAL GUIDELINE IN FORMULATING SITE SPECIFIC ENGINEERING DRAWINGS. NO DESCRIPTION OF MATERIALS OR THIS DESIGN CREATES OR AMOUNTS TO AN EXPRESS WARRANTY, OR IMPLIED WARRANTY OF MERCHANTABILITY OR FITNESS FOR A PARTICULAR PURPOSE.

DRAWN

Don

DATE

12/15/98

REVISION

1

DWG. NO.

D-BT017

GSE CurtainWall® Panel Fabrication Details

Job Name & Location: _____

Ordered By: _____

Date Submitted _____

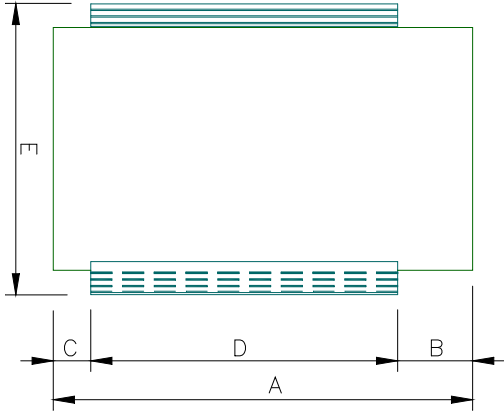

A = Total Panel Length
B = Length of Top Flap
(liner only)
C = Length of Bottom Flap
(liner only)
D = Length if Interlock
E = Width of Panel
(0. to 0. of Interlock)

	Size 1	Size 2	Size 3	Size 4	Size 5
Number of Panels					
Sheet Mil Thickness					
Anchors (Yes/No)					
Dim A					
Dim B					
Dim C					
Dim D					
Dim E					

Questions

- 1.) Are CurtainWall Interlocks The same or opposing directions? _____
- 2.) If the CurtainWall Panels include anchors, please draw the orientation of the anchor to the Interlocks.

Please detail the orientation of the Interlock and anchor lengths
(Top view of inserted panel in ground)



GSE Lining Technology, Inc.
19103 Gundle Road
Houston, Texas 77073-3598
(800)435-2008 / (281)443-8564

NO PART OF THIS DOCUMENT MAY BE REPRODUCED OR DISTRIBUTED IN ANY FORM OR BY ANY MEANS, OR STORED IN A DATA BASE OR RETRIEVAL SYSTEM, WITHOUT THE PRIOR WRITTEN PERMISSION OF GSE Lining Technology, Inc.

DRAWN

Don

DATE

12/15/98

REVISION

1

DWG. NO.

D-CW018

THIS IS A CONCEPTUAL DRAWING SOLELY FOR USE BY ENGINEERS AS A GENERAL GUIDELINE IN FORMULATING SITE SPECIFIC ENGINEERING DRAWINGS. NO DESCRIPTION OF MATERIALS OR THIS DESIGN CREATES OR AMOUNTS TO AN EXPRESS WARRANTY, OR IMPLIED WARRANTY OF MERCHANTABILITY OR FITNESS FOR A PARTICULAR PURPOSE.

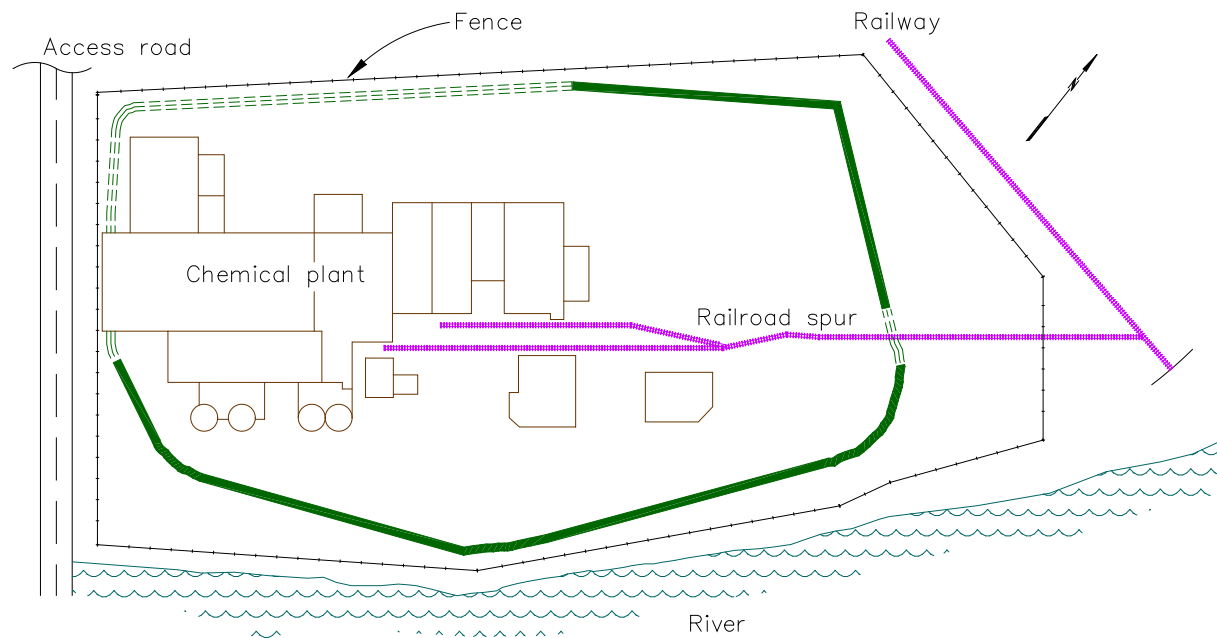

GSE Curtain Wall System Project At A Chemical Plant

Key Plan (Not to scale)

Legend

GSE Curtain Wall System



Jet Grouting



GSE Lining Technology, Inc.

19103 Gundie Road
Houston, Texas 77073-3598
(800)435-2008 / (281)443-8564

NO PART OF THIS DOCUMENT MAY BE REPRODUCED OR DISTRIBUTED IN ANY FORM OR BY ANY MEANS, OR STORED IN A DATA BASE OR RETRIEVAL SYSTEM, WITHOUT THE PRIOR WRITTEN PERMISSION OF GSE Lining Technology, Inc.

DRAWN

Don

DATE

12/15/98

REVISION

1

DWG. NO.

D-CW019

THIS IS A CONCEPTUAL DRAWING SOLELY FOR USE BY ENGINEERS AS A GENERAL GUIDELINE IN FORMULATING SITE SPECIFIC ENGINEERING DRAWINGS. NO DESCRIPTION OF MATERIALS OR THIS DESIGN CREATES OR AMOUNTS TO AN EXPRESS WARRANTY, OR IMPLIED WARRANTY OF MERCHANTABILITY OR FITNESS FOR A PARTICULAR PURPOSE.

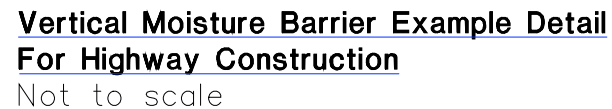

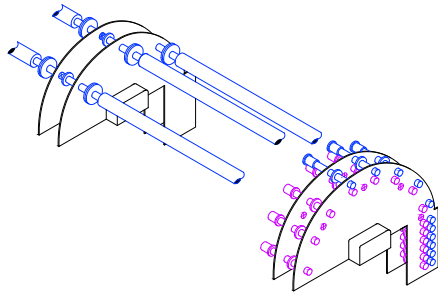

Partial Isometric View
Not to scale

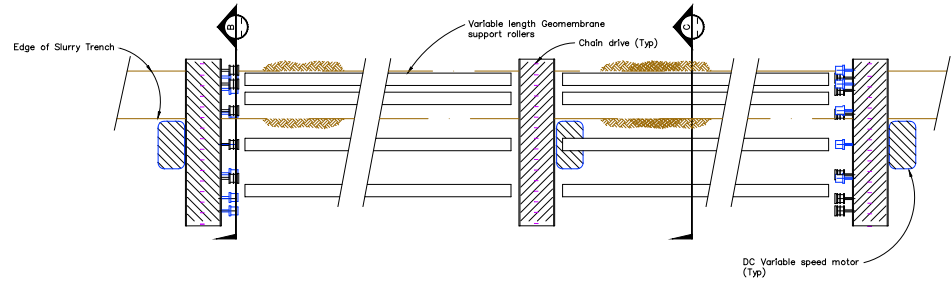

Plan View
Not to scale

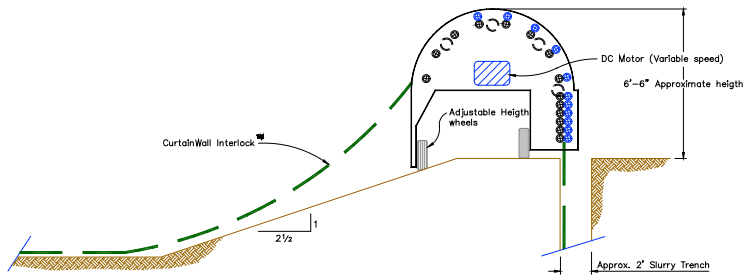

Typical Section
Not to scale

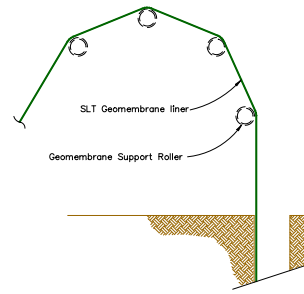

Section C
Not to scale

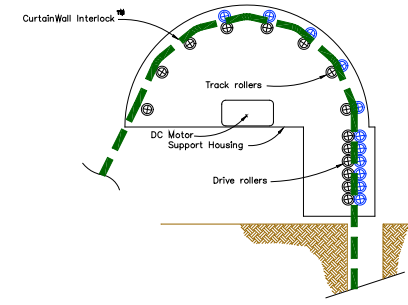

Section B
Not to scale

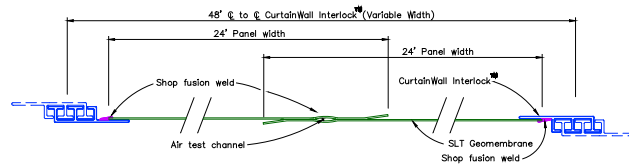

Typical Panel Cross-Section
Not to scale

Patent Pending



GSE Lining Technology, Inc.
19103 Gundie Road
Houston, Texas 77073-3598
(800)435-2008 / (281)443-8564

NO PART OF THIS DOCUMENT MAY BE REPRODUCED OR DISTRIBUTED IN ANY FORM OR BY ANY MEANS, OR STORED IN A DATA BASE OR RETRIEVAL SYSTEM, WITHOUT THE PRIOR WRITTEN PERMISSION OF GSE Lining Technology, Inc.

THIS IS A CONCEPTUAL DRAWING SOLELY FOR USE BY ENGINEERS AS A GENERAL GUIDELINE IN FORMULATING SITE SPECIFIC ENGINEERING DRAWINGS. NO DESCRIPTION OF MATERIALS OR THIS DESIGN CREATES OR AMOUNTS TO AN EXPRESS WARRANTY, OR IMPLIED WARRANTY OF MERCHANTABILITY OR FITNESS FOR A PARTICULAR PURPOSE.

DRAWN

Don

DATE

12/15/98

REVISION

1

DWG. NO.

D-CW021

GSE GundWall™ Panel Fabrication Details

Job Name & Location: _____
Ordered By: _____
Date Submitted _____

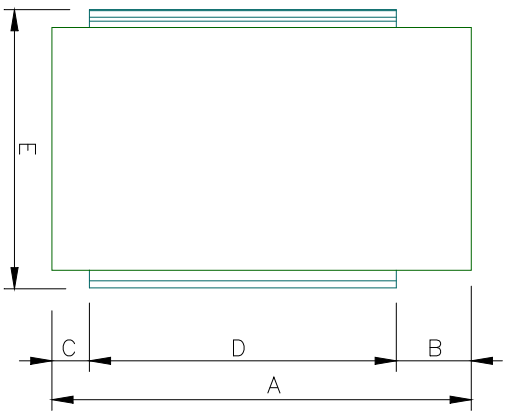

A = Total Panel Length
B = Length of Top Flap
(Liner only)
C = Length of Bottom Flap
(Liner only)
D = Length if Interlock
E = Width of Panel
(0. to 0. of Interlock)

	Size 1	Size 2	Size 3	Size 4	Size 5
Number of Panels					
Sheet Mil Thickness					
Anchors (Yes/No)					
Dim A					
Dim B					
Dim C					
Dim D					
Dim E					

Questions

1.) Please draw orientation of interlocks (Please label male or female) and anchor lengths. Include any special details to be mentioned.
(Top view of inserted panel in ground)



GSE Lining Technology, Inc.
19103 Gundle Road
Houston, Texas 77073-3598
(800)435-2008 / (281)443-8564

NO PART OF THIS DOCUMENT MAY BE REPRODUCED OR DISTRIBUTED IN ANY FORM OR BY ANY MEANS, OR STORED IN A DATA BASE OR RETRIEVAL SYSTEM, WITHOUT THE PRIOR WRITTEN PERMISSION OF GSE Lining Technology, Inc.

DRAWN Don DATE 12/15/98

THIS IS A CONCEPTUAL DRAWING SOLELY FOR USE BY ENGINEERS AS A GENERAL GUIDELINE IN FORMULATING SITE SPECIFIC ENGINEERING DRAWINGS. NO DESCRIPTION OF MATERIALS OR THIS DESIGN CREATES OR AMOUNTS TO AN EXPRESS WARRANTY, OR IMPLIED WARRANTY OF MERCHANTABILITY OR FITNESS FOR A PARTICULAR PURPOSE.

REVISION 1 DWG. NO. D-CW022

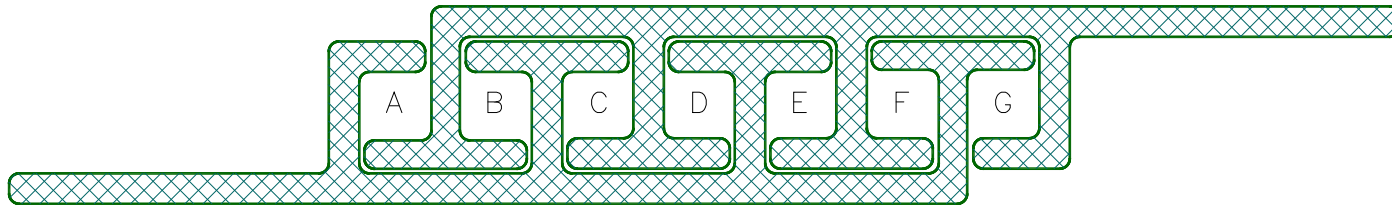

A thru G are potential monitoring or sealant chambers

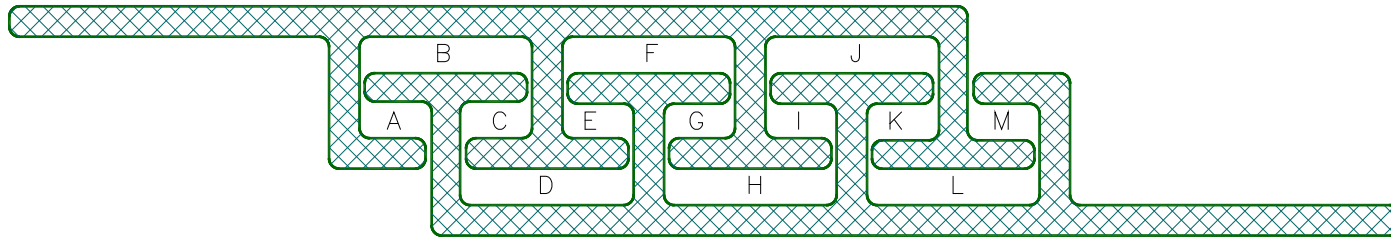

A thru M are potential monitoring or sealant chambers

GSE CurtainWall Interlock[®], Connection and Joint

(Patented and other patents pending)
Scale = Full



GSE Lining Technology, Inc.
19103 Gundle Road
Houston, Texas 77073-3598
(800)435-2008 / (281)443-8564

NO PART OF THIS DOCUMENT MAY BE REPRODUCED OR DISTRIBUTED IN ANY FORM OR BY ANY MEANS, OR STORED IN A DATA BASE OR RETRIEVAL SYSTEM, WITHOUT THE PRIOR WRITTEN PERMISSION OF GSE Lining Technology, Inc.

DRAWN

Don

DATE

12/15/98

REVISION

1

DWG. NO.

D-CW023

THIS IS A CONCEPTUAL DRAWING SOLELY FOR USE BY ENGINEERS AS A GENERAL GUIDELINE IN FORMULATING SITE SPECIFIC ENGINEERING DRAWINGS. NO DESCRIPTION OF MATERIALS OR THIS DESIGN CREATES OR AMOUNTS TO AN EXPRESS WARRANTY, OR IMPLIED WARRANTY OF MERCHANTABILITY OR FITNESS FOR A PARTICULAR PURPOSE.

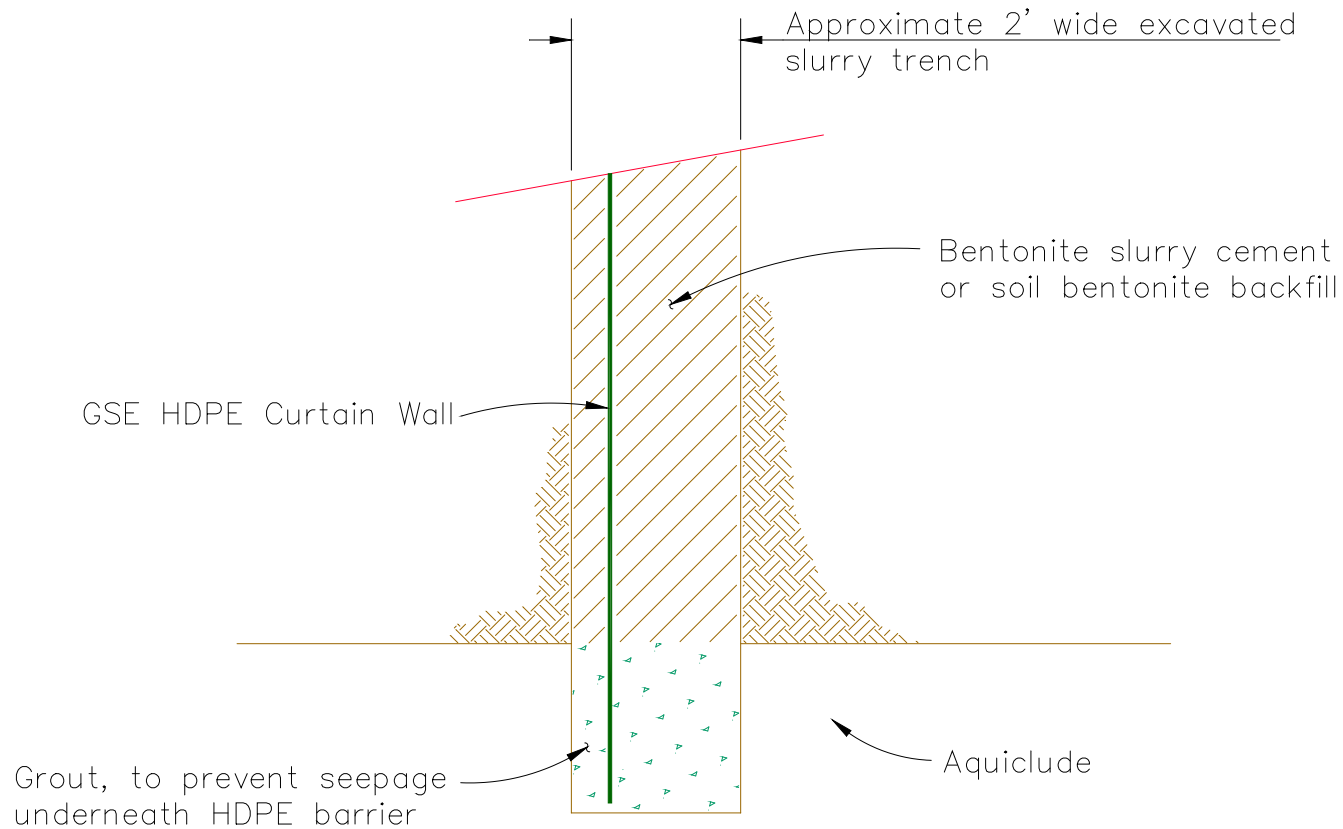

GSE HDPE Curtain Wall Keyed Into Aquiclude With Grout

Not to scale



GSE Lining Technology, Inc.

19103 Gundie Road
Houston, Texas 77073-3598
(800)435-2008 / (281)443-8564

NO PART OF THIS DOCUMENT MAY BE REPRODUCED OR DISTRIBUTED IN ANY FORM OR BY ANY MEANS, OR STORED IN A DATA BASE OR RETRIEVAL SYSTEM, WITHOUT THE PRIOR WRITTEN PERMISSION OF GSE Lining Technology, Inc.

THIS IS A CONCEPTUAL DRAWING SOLELY FOR USE BY ENGINEERS AS A GENERAL GUIDELINE IN FORMULATING SITE SPECIFIC ENGINEERING DRAWINGS. NO DESCRIPTION OF MATERIALS OR THIS DESIGN CREATES OR AMOUNTS TO AN EXPRESS WARRANTY, OR IMPLIED WARRANTY OF MERCHANTABILITY OR FITNESS FOR A PARTICULAR PURPOSE.

DRAWN

Don

DATE

12/15/98

REVISION

1

DWG. NO.

D-CW024

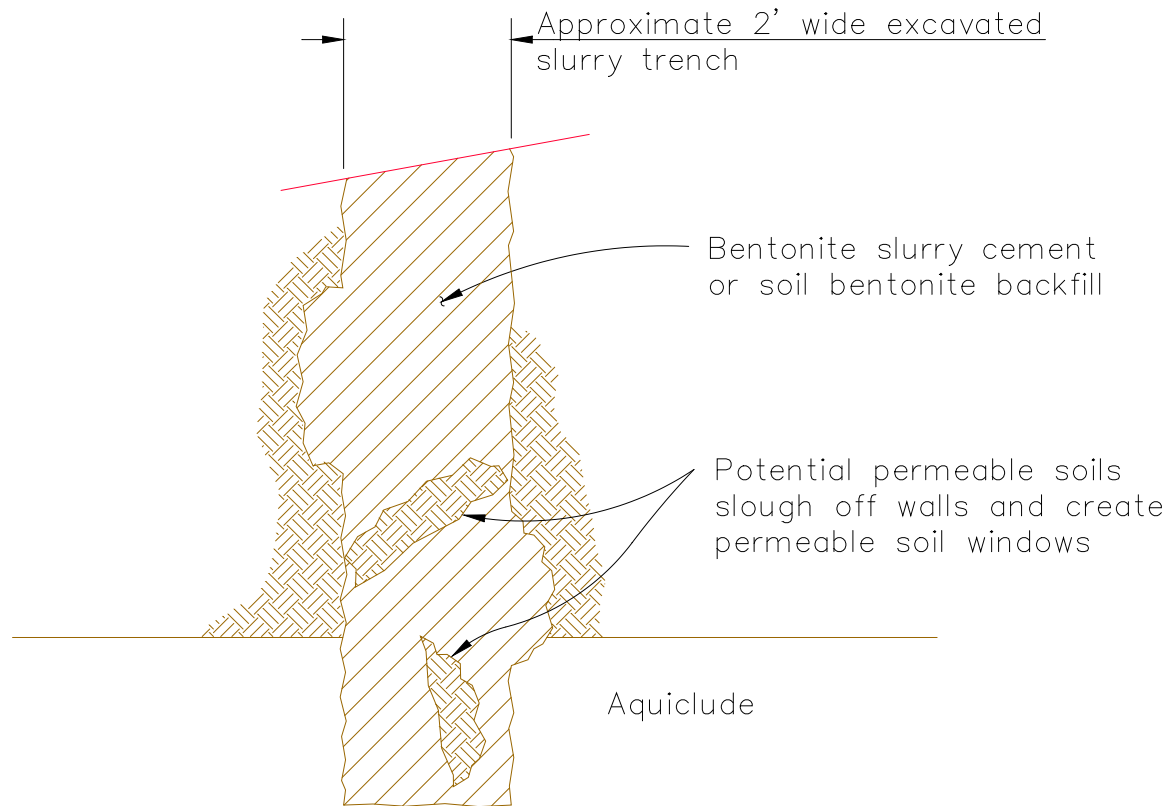

Cross-Section Of Soil Bentonite, Cement Bentonite, Or Deep soil Mixed Walls With Permeable Soil Windows

Not to scale



GSE Lining Technology, Inc.

19103 Gundle Road
Houston, Texas 77073-3598
(800)435-2008 / (281)443-8564

NO PART OF THIS DOCUMENT MAY BE REPRODUCED OR DISTRIBUTED IN ANY FORM OR BY ANY MEANS, OR STORED IN A DATA BASE OR RETRIEVAL SYSTEM, WITHOUT THE PRIOR WRITTEN PERMISSION OF GSE Lining Technology, Inc.

THIS IS A CONCEPTUAL DRAWING SOLELY FOR USE BY ENGINEERS AS A GENERAL GUIDELINE IN FORMULATING SITE SPECIFIC ENGINEERING DRAWINGS. NO DESCRIPTION OF MATERIALS OR THIS DESIGN CREATES OR AMOUNTS TO AN EXPRESS WARRANTY, OR IMPLIED WARRANTY OF MERCHANTABILITY OR FITNESS FOR A PARTICULAR PURPOSE.

DRAWN

Don

DATE

12/15/98

REVISION

1

DWG. NO.

D-CW025

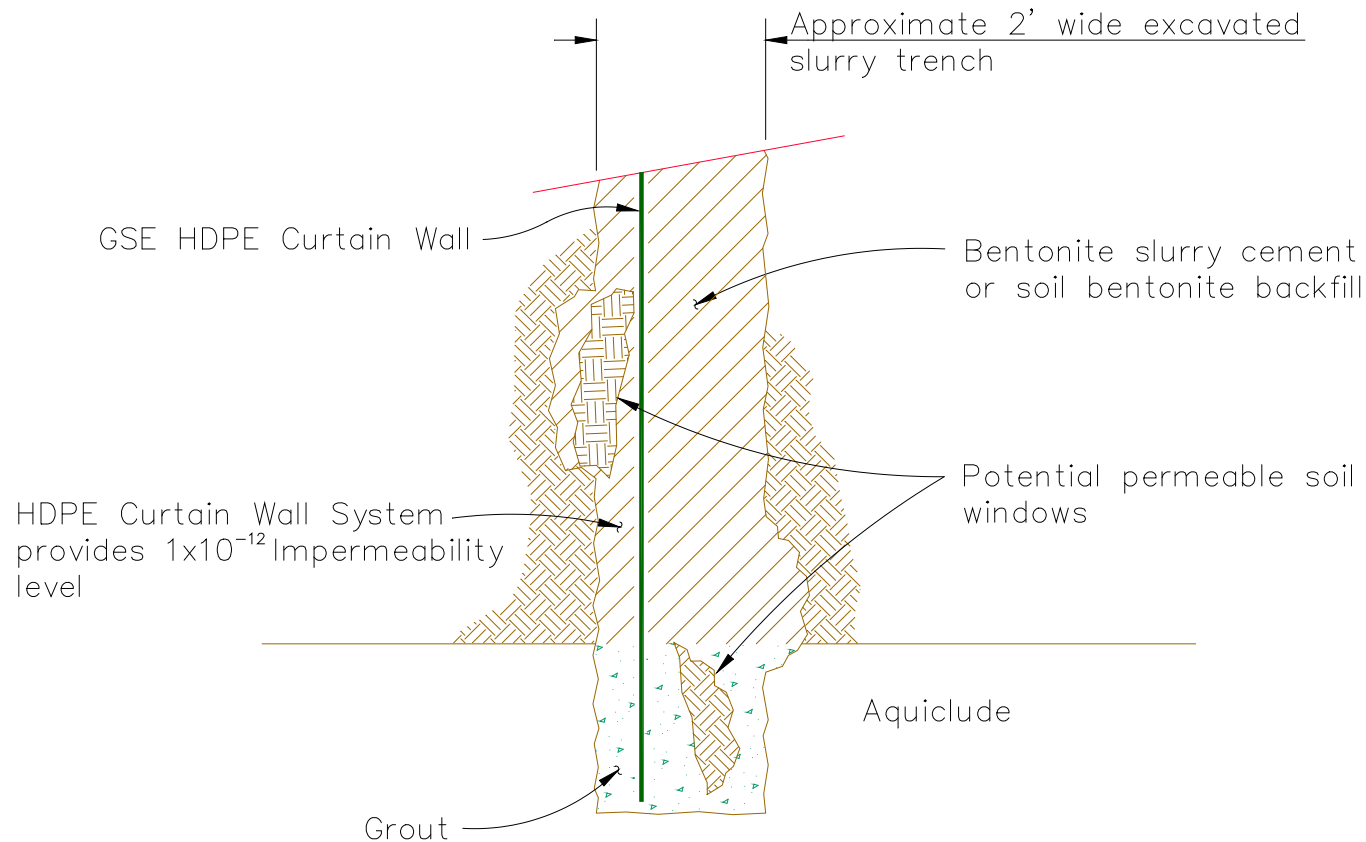

Composite Barrier Wall With GSE HDPE Curtain Wall And Soil Bentonite Or Cement Bentonite Backfill

Not to scale



GSE Lining Technology, Inc.

19103 Gundle Road
Houston, Texas 77073-3598
(800)435-2008 / (281)443-8564

NO PART OF THIS DOCUMENT MAY BE REPRODUCED OR DISTRIBUTED IN ANY FORM OR BY ANY MEANS, OR STORED IN A DATA BASE OR RETRIEVAL SYSTEM, WITHOUT THE PRIOR WRITTEN PERMISSION OF GSE Lining Technology, Inc.

THIS IS A CONCEPTUAL DRAWING SOLELY FOR USE BY ENGINEERS AS A GENERAL GUIDELINE IN FORMULATING SITE SPECIFIC ENGINEERING DRAWINGS. NO DESCRIPTION OF MATERIALS OR THIS DESIGN CREATES OR AMOUNTS TO AN EXPRESS WARRANTY, OR IMPLIED WARRANTY OF MERCHANTABILITY OR FITNESS FOR A PARTICULAR PURPOSE.

DRAWN

Don

DATE

12/15/98

REVISION

1

DWG. NO.

D-CW026

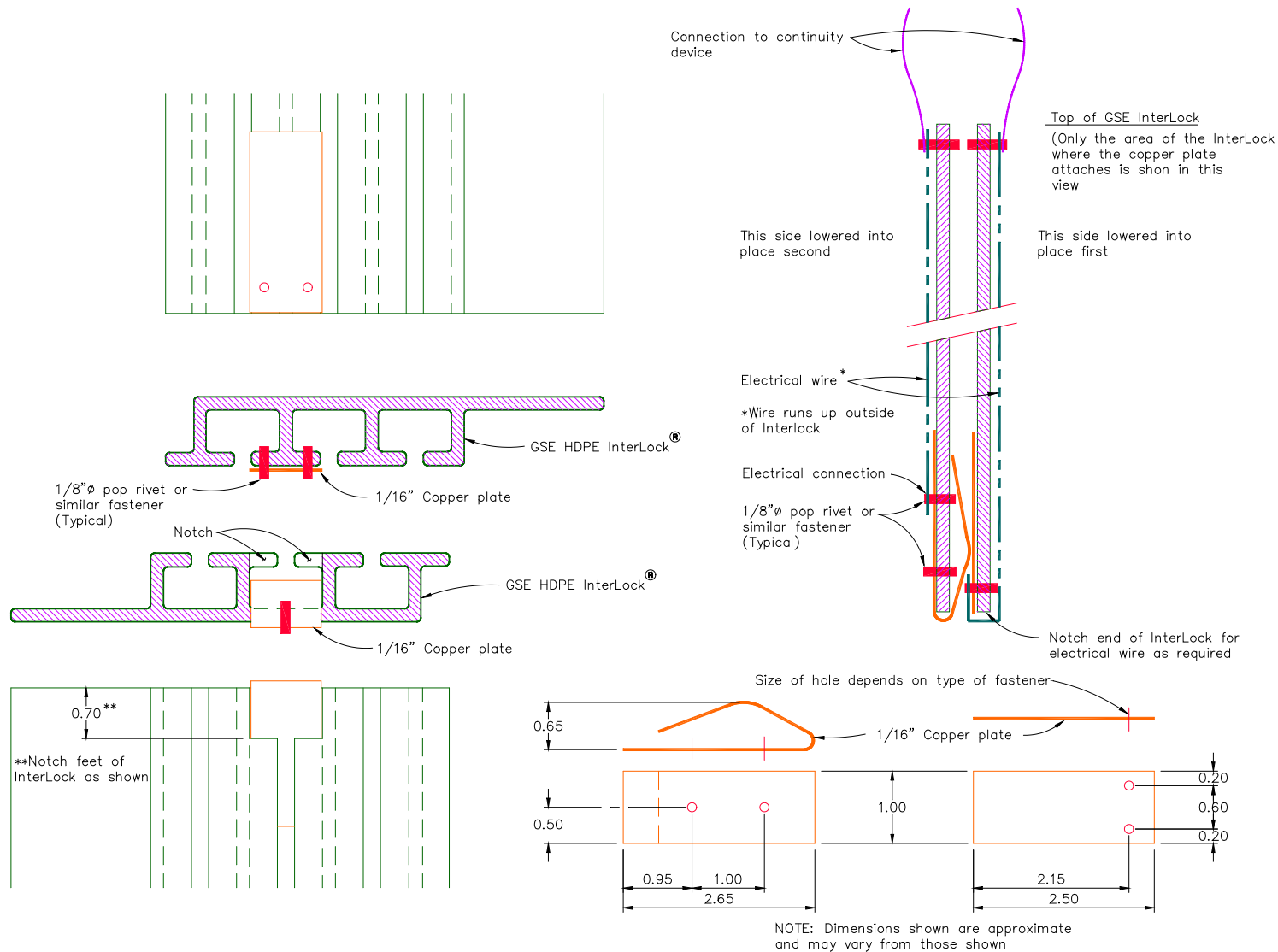

Typical Electrical Verification Device (EVD) For CurtainWall®

Not to scale



GSE Lining Technology, Inc.

19103 Gundle Road
Houston, Texas 77073-3598
(800)435-2008 / (281)443-8564

NO PART OF THIS DOCUMENT MAY BE REPRODUCED OR DISTRIBUTED IN ANY FORM OR BY ANY MEANS, OR STORED IN A DATA BASE OR RETRIEVAL SYSTEM, WITHOUT THE PRIOR WRITTEN PERMISSION OF GSE Lining Technology, Inc.

THIS IS A CONCEPTUAL DRAWING SOLELY FOR USE BY ENGINEERS AS A GENERAL GUIDELINE IN FORMULATING SITE SPECIFIC ENGINEERING DRAWINGS. NO DESCRIPTION OF MATERIALS OR THIS DESIGN CREATES OR AMOUNTS TO AN EXPRESS WARRANTY, OR IMPLIED WARRANTY OF MERCHANTABILITY OR FITNESS FOR A PARTICULAR PURPOSE.

DRAWN

Don

DATE

12/15/98

REVISION

1

DWG. NO.

D-CW027

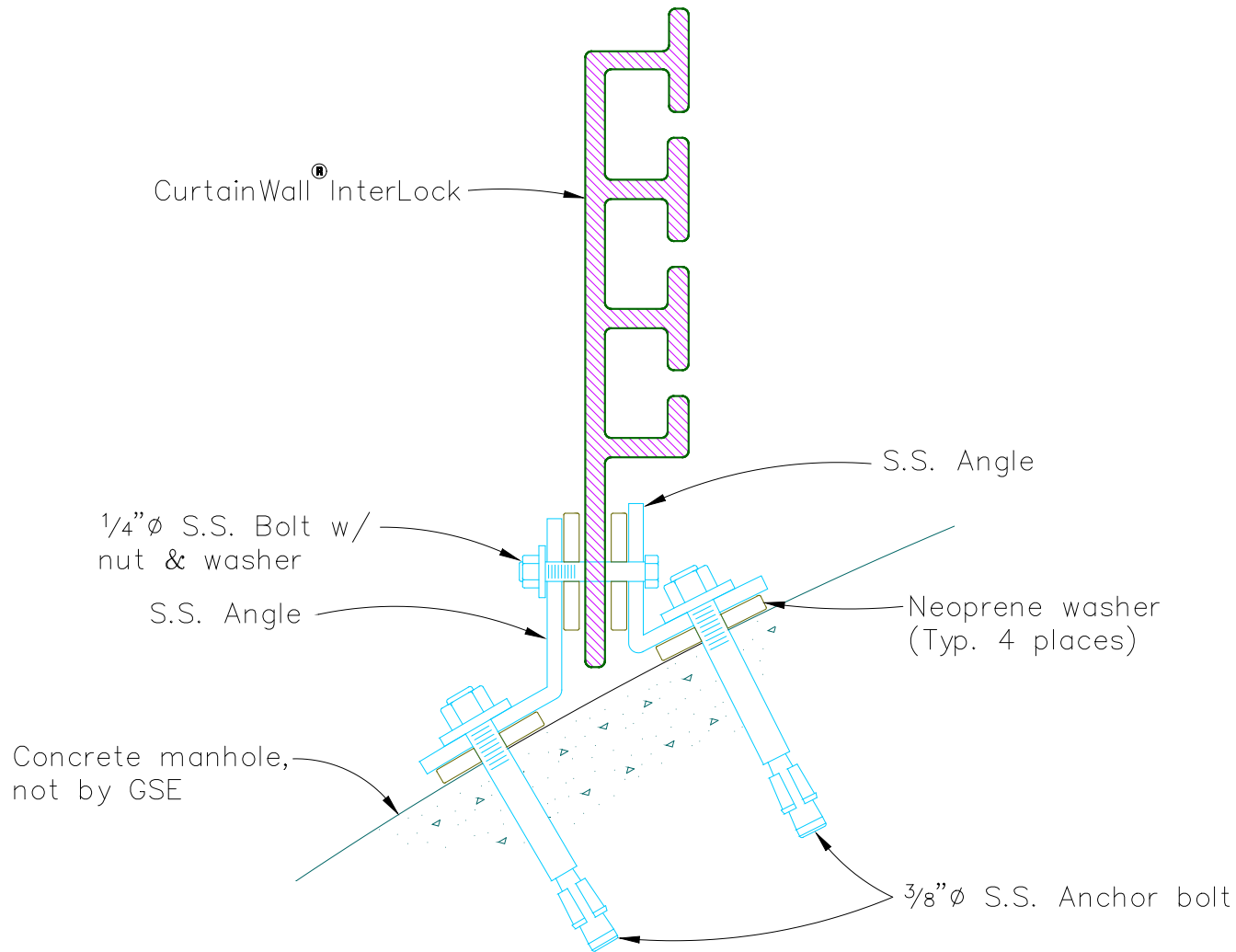

GSE CurtainWall® Attachment To Concrete Structure

Not to scale



GSE Lining Technology, Inc.

19103 Gundle Road
Houston, Texas 77073-3598
(800)435-2008 / (281)443-8564

NO PART OF THIS DOCUMENT MAY BE REPRODUCED OR DISTRIBUTED IN ANY FORM OR BY ANY MEANS, OR STORED IN A DATA BASE OR RETRIEVAL SYSTEM, WITHOUT THE PRIOR WRITTEN PERMISSION OF GSE Lining Technology, Inc.

THIS IS A CONCEPTUAL DRAWING SOLELY FOR USE BY ENGINEERS AS A GENERAL GUIDELINE IN FORMULATING SITE SPECIFIC ENGINEERING DRAWINGS. NO DESCRIPTION OF MATERIALS OR THIS DESIGN CREATES OR AMOUNTS TO AN EXPRESS WARRANTY, OR IMPLIED WARRANTY OF MERCHANTABILITY OR FITNESS FOR A PARTICULAR PURPOSE.

DRAWN

Don

DATE

12/15/98

REVISION

1

DWG. NO.

D-CW028

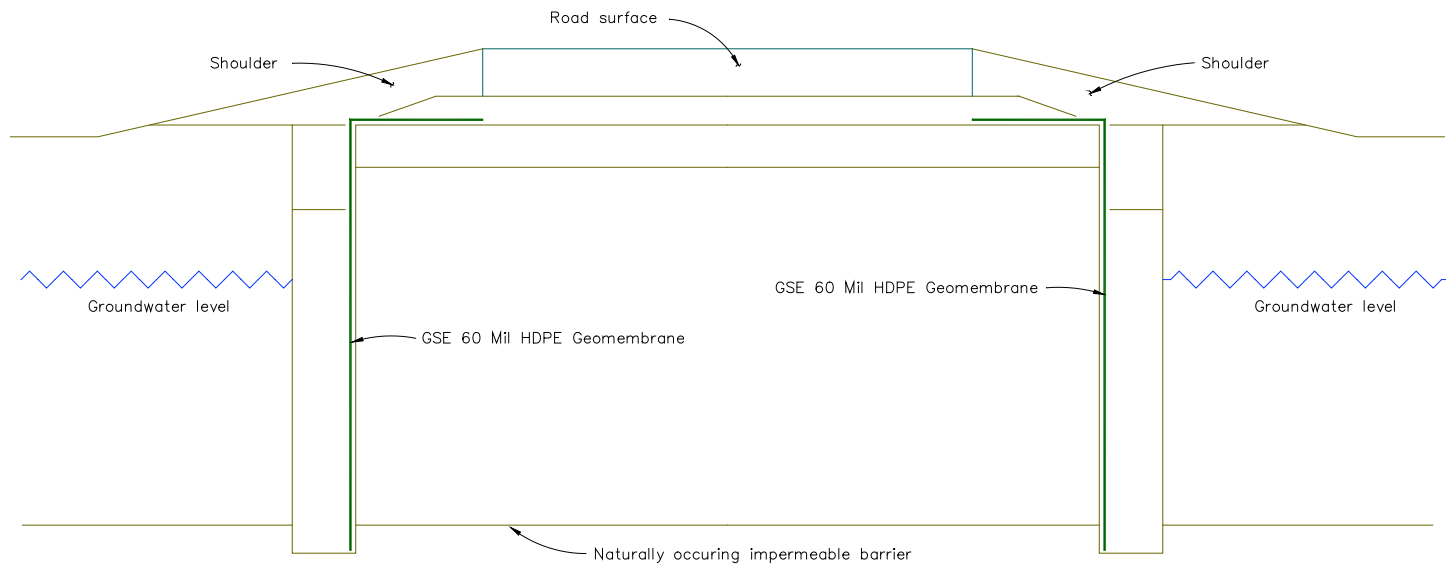

**Cutaway View Of Highway Construction Detail W/ Vertical Barrier
To Prevent Flow Of Groundwater Under Roadway**



GSE Lining Technology, Inc.

19103 Gundie Road
Houston, Texas 77073-3598
(800)435-2008 / (281)443-8564

NO PART OF THIS DOCUMENT MAY BE REPRODUCED OR DISTRIBUTED IN ANY FORM OR BY ANY MEANS, OR STORED IN A DATA BASE OR RETRIEVAL SYSTEM, WITHOUT THE PRIOR WRITTEN PERMISSION OF GSE Lining Technology, Inc.

THIS IS A CONCEPTUAL DRAWING SOLELY FOR USE BY ENGINEERS AS A GENERAL GUIDELINE IN FORMULATING SITE SPECIFIC ENGINEERING DRAWINGS. NO DESCRIPTION OF MATERIALS OR THIS DESIGN CREATES OR AMOUNTS TO AN EXPRESS WARRANTY, OR IMPLIED WARRANTY OF MERCHANTABILITY OR FITNESS FOR A PARTICULAR PURPOSE.

DRAWN

Don

DATE

12/15/98

REVISION

1

DWG. NO.

D-CW029